

Contact Us

Thank you for choosing our products! If you have any questions or comments, contact us at support@viribusbikes.com and we'll resolve your issue ASAP!

For a .pdf copy of the latest version of these instructions, use the appropriate app on your smartphone to scan the QR code.



Adult Bicycle

User Manual

Read Carefully Before Use
Keep for Future Reference



Disclaimer

Read this disclaimer completely and carefully before proceeding with the rest of the manual content.

1. As-Is

This Viribus product is sold 'as is' and without any express or implied warranties, including but not limited to the implied warranties of merchantability and fitness for a particular purpose.

2. Product Modifications

Any modifications or alterations to Viribus products void any warranties and may result in damage or injury. Viribus shall not be liable for any damages resulting from such modifications or alterations.

3. Compliance with Laws

Customers shall be liable for ensuring that the use of Viribus products complies with all applicable laws and regulations in their respective jurisdictions. Viribus assumes no responsibility for any violations of laws or regulations resulting from the use of Viribus products.

4. Correct Use

Always use Viribus products only as directed in the accompanying manuals. Failure to follow instructions may result in injury or damage.

Always ensure the assembly, installation, operation, maintenance,

or repair of Viribus products is carried out by a competent person.

Always make maintenance regularly throughout Viribus products' lifecycles; you have the liability to keep the products operating as intended.

Always wear appropriate protective gear.

5. Third-Party Products

Viribus shall not be liable for any damages or losses resulting from the use of third-party products in conjunction with Viribus products. Customers shall refer to the third-party's guidelines or/and warranties (if any) for any third-party products used.

6. Limitation of Liability

Viribus shall not be liable for any direct, indirect, punitive, incidental, special, or consequential damages to property or life, whatsoever arising out of or connected with the use or misuse of Viribus products. In no event shall Viribus's liability exceed the value of the products sold.

This disclaimer states the entire obligation of Viribus with respect to Viribus products. If any part of this disclaimer is determined to be void, invalid, unenforceable, or illegal, including but not limited to the warranty disclaimers, liability disclaimers, and liability limitations set forth above, the invalid or unenforceable provision will be deemed superseded by a valid and enforceable provision that most closely matches the intent of the original provision and the remainder of the agreement shall remain in full force and effect.

Contents

Safety Information.....	1	Operation	19
General Notice	1	Charging	19
Traffic Rules.....	1	Turning ON/OFF the Bike.....	20
Clothing	1	Riding with Throttle Control	21
Safety Checks	2	Riding with Pedal Assist Control	21
Sensible Use	2	Riding with Push Assist Control.....	22
Product Diagram.....	4	Riding with Manual Control	22
Overview	5	Adjustment Menus	22
Parts and Tools	5	Maintenance	23
Assembly.....	7	Troubleshooting.....	24
Installing the Front Wheel	8	Disposal.....	24
Installing the Handlebars	10		
Installing the Front Fender and Stay	11		
Installing the Rear Fender Stay	14		
Installing the Rear Reflector and Rack.....	14		
Installing the Front Basket	16		
Installing the Saddle	17		
Installing the Pedals	18		
Installing the Bell.....	19		
Installing the Front Reflector	19		
Post-assembly Actions.....	20		

Safety Information

Warning

General Notice

- Read **ALL** these instructions completely before assembly and use. Contact customer service if any point is unclear.
- Provide this manual to anyone who will use this bicycle and provide it with this bicycle (whether already assembled or not) if it is ever given or sold to a third party.
- **ONLY** assemble and use this bicycle following these instructions. Failure to do so may lead to serious property damage and severe personal injury.
- This bicycle is designed for road use. Use on mountain terrain may pose safety hazards.

Traffic Rules

- **ALWAYS** obey **ALL** applicable local and national laws and regulations while riding.
- **DO NOT** allow use by children, by persons unfamiliar with this bicycle or these instructions, or by anyone whose physical or mental impairment precludes safe use.
- **DO NOT** ride this bicycle while tired or under the influence of drugs or medication.
- **DO NOT** ride this bicycle in areas where manual bicycles are prohibited.
- **ALWAYS** maintain your reflectors and other required safety equipment.

- It is advisable to equip your bicycle with a warning device such as a horn, bell, and light in case you are riding at times of poor visibility. This is **EVEN** required in some jurisdictions.

Clothing

- **ALWAYS** wear appropriate hand protection during assembly, disassembly, adjustment, or repair of this bicycle.
- **DO NOT** wear loose footwear or clothing that may become caught in the wheels or any other moving parts while riding.
- **DO NOT** ride this bicycle with bare feet.

ALWAYS wear closed-toe shoes with good traction to maintain grip on the pedals and provide protection for your feet.

- **ALWAYS** wear a helmet and other required protective gears that meet safety standards while riding.

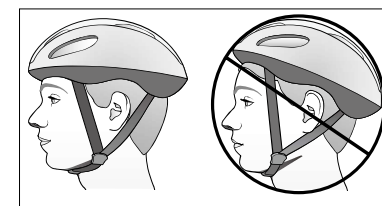

- Gloves with grip padding are strongly recommended for riding, as they can strengthen your hold on the handlebars and protect your hands in case of a fall.
- Wear sunglasses or other clear protective eyewear to shield your eyes from dust, debris, and insects.

- In sunny conditions, it is advisable to apply sunscreen to exposed skin, especially for long rides.
- For best results, choose brightly colored or reflective clothing or attach reflective accessories or strips to your clothing to enhance visibility from all angles, especially during low-light conditions.



Safety Checks

- **ALWAYS** check that **BOTH** the front and rear brakes are positioned properly **BEFORE** riding.
- **ALWAYS** check that **ALL** components and fasteners are intact and securely tightened **BEFORE** and **AFTER** riding.
- Regularly check the reflectors to make sure that they are clean, straight, unbroken, and securely mounted. Also, perform this check for the front light.

Riding with low light or without lights or reflectors is **EXTREMELY** dangerous.

- **DO NOT** ride this bicycle if any part is damaged or shows any sign of malfunction. Repair or replace worn and broken components before further use, especially bent or broken spokes and wheel rims.
- **NEVER** replace any components or fasteners with nonidentical ones.

Sensible Use

- **ONLY** allow one person to use this bicycle at a time.

- **DO NOT** carry children in the front basket or on the rear rack. If carrying pets, ensure that this act is permitted in your jurisdiction and they are safely secured with comfort.
- **NEVER** ride at a speed where your stopping distance exceeds your visibility.
- For optimal safety, it is **NOT** recommended to ride your bicycle at night or in environments with poor visibility (e.g., foggy or snowy conditions).

If you have an emergency that makes it necessary, keep your light on and limit your speed appropriately.

- It is recommended that you **NOT** ride your bicycle fast **UNTIL** you are **FULLY** familiar with this new bicycle and its controls. However, even when you are familiar with the bicycle, **ALWAYS** be mindful of your speed, ensuring that you have sufficient room to brake in an emergency.
- **DO NOT** ride this bicycle in extreme weather conditions, such as thunderstorms and hurricanes. If you meet with them during a ride, stop your bicycle, find a safe shelter, and wait until they pass.
- When meeting a strong wind, keep a firm grip on the handlebars, lean into the wind, and adjust your position as needed to maintain control.
- In wet weather, be careful to avoid sharp turns, which are easy to cause an accidental fall.



- **ALWAYS** be alert for people, animals, or any obstacles that may appear in front of you while riding your bicycle.

ALWAYS be careful of passing parked cars, whose doors might open suddenly.

ALWAYS be aware that pedestrians and drivers may not expect the speed or responsiveness of your bicycle. Adjust your behavior accordingly.

It is advisable to install warning devices to draw their attention, **BUT** always be ready to turn safely out of their way if needed.

- **ALWAYS** be careful at road and rail crossings. Slow down and check both ways for oncoming traffic.
- **DO NOT** ride this bicycle near precipices or on highly uneven, sandy, or sloped surfaces.
- **DO NOT** carry packages or objects on your bicycle in a way that obstructs your view of the road.
- **DO NOT** use harsh abrasives or caustic chemicals to maintain this bicycle.
- **DO NOT** load this bicycle with more than 260 pounds (120 kg), including 22 pounds (10 kg) in the front basket and 55 pounds (25 kg) on the rear rack.
- **DO NOT** exceed 45 psi (3 bar) when pumping up the wheel tires.

Product Diagram

Overview

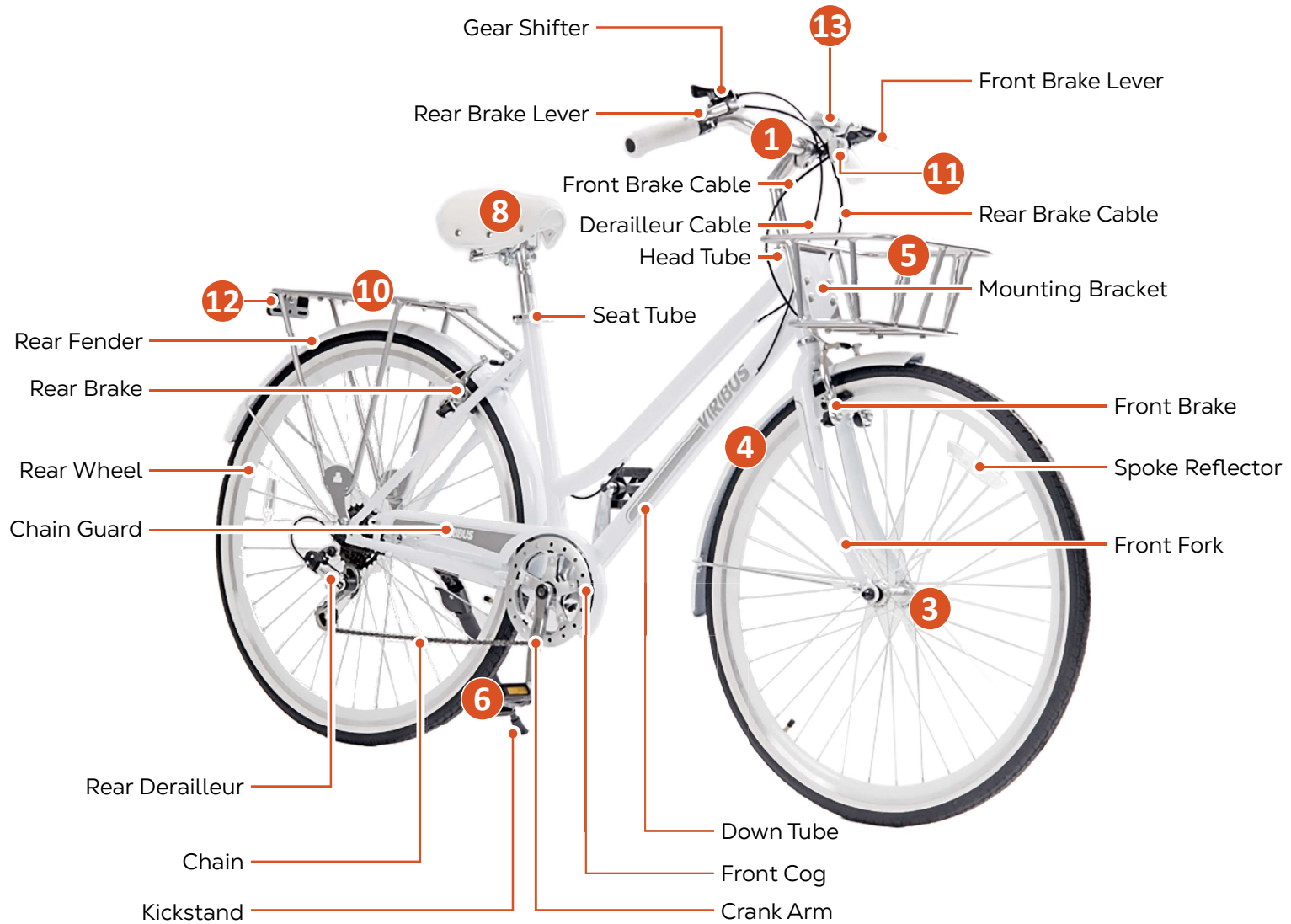



Parts and Tools

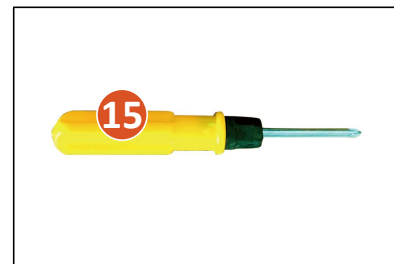

Item	Name	Qty.
1	Handlebars	1
2	Main Frame	1
3	Front Wheel	1
4	Front Fender with Stay	1
5	Front Basket	1
6	Pedals	2
7	Quick Release Lever	1
8	Saddle	1
9	Saddle Post	1
10	Rear Rack	1
11	Front Reflector	1
12	Rear Reflector	1
13	Bell	1
14	Handlebars Cap	1
15	Flathead/Phillips Screwdriver	1
16	5 mm Hex Wrench	1
17	6 mm Hex Wrench	1
18	Multifunctional Wrench	1

Not Included but Helpful

- Work Gloves
- Goggles
- Adjustable Wrench

Note

When you first receive your new tricycle, carefully unpack all these parts and check that nothing is missing or has been damaged in transit. If necessary, ask your local dealer or contractor for supplements or replacements.

Besides, storing your original packaging through the warranty period will speed returns if any are needed.

Assembly

Warning

Put on hand and eye protection during assembly to prevent accidents. Work gloves and goggles (not included) are strongly recommended.

For your convenience, all bolts, nuts, and washers are preinstalled where they will be needed.

During assembly, remove the fasteners as needed and keep them nearby.

Reinstall them to connect each part as you go and tighten them securely for a safe and satisfactory experience.

Installing the Front Wheel

Parts and Tools

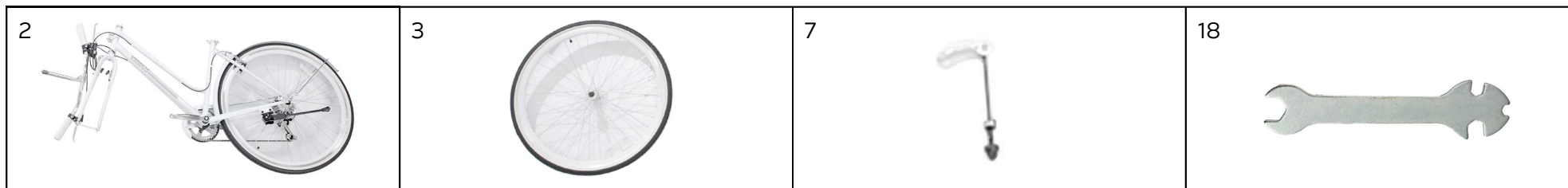

Steps

1. Kick the kickstand into the vertical position and use it to hold the main frame (2) upright.
2. Loosen the bolts on the protective bar between the front fork with the multifunctional wrench (18) and then remove the bar from the fork.
3. Press and disconnect the front V-brake on the main frame's front fork.
4. Place the front wheel (3) into the front fork, allowing the fork to catch its axle snugly.
5. Loosen the nut of the quick release lever (7) to remove it and the spring. Place them nearby.
6. Insert the quick release lever into the axle hole of the front wheel.

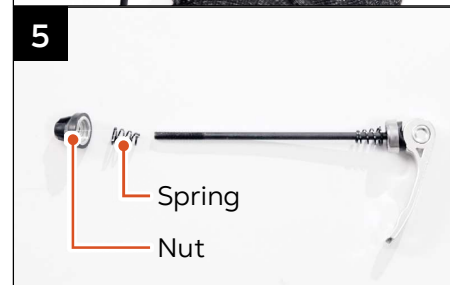
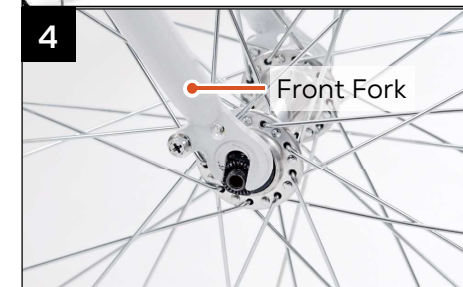

7. Replace the removed spring to the quick release lever and ensure that the side of the spring with a larger diameter is on the outside, and the side with a smaller diameter is on the inside.
8. Replace the removed nut to the quick release lever and hand tighten the nut.
9. Hand tighten the handle of the quick release lever.
10. Press the handle down.



Installing the Handlebars

Parts and Tools

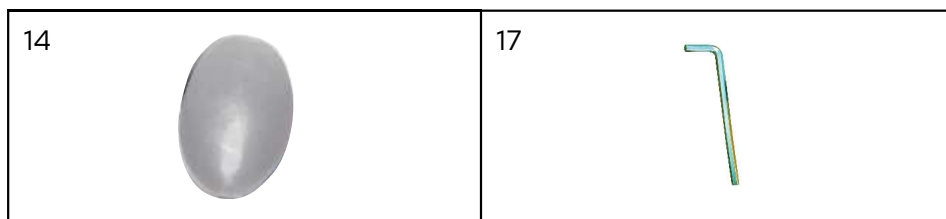

Steps

1. Loosen the bolt at the top of the steering tube of the handlebars (2) using the 6 mm hex wrench (17).
2. Slide the steering tube into the head tube until your desired height is reached and ensure the handlebars are perpendicular to the down tube.
3. Retighten the top bolt with the 6 mm hex wrench to secure the steering tube into place, making sure that the bend part of the steering tube is aligned with the head tube.
4. Loosen the front bolt of the handlebars with the 6 mm hex wrench.
5. Adjust the position of the handlebars' stem as needed.
6. Retighten the front bolt with the 6 mm hex wrench to secure the stem.
7. Attach the handlebars cap (14) to the top bolt of the handlebars and press it into place.

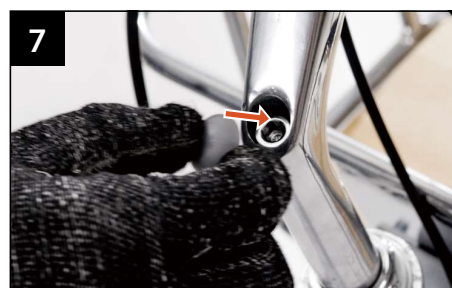
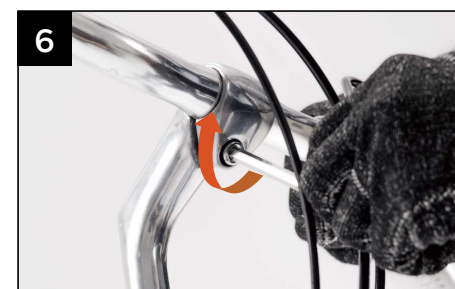

Installing the Front Fender and Stay

Parts and Tools

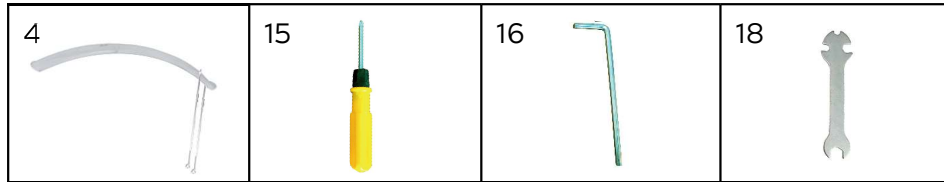

Steps

1. Use the Phillips screwdriver (15) and the multifunctional wrench (18) to loosen and remove the bolt with the nut and washer preinstalled on the front fork. Place them nearby.
2. Pass the front fender (4) through the front fork, aligning its slot with the hole on the top of the front fork.
3. Insert the removed bolt through the hole and slot.
4. Replace the washer and nut to the bolt, and tighten them with the multifunctional wrench and the Phillips screwdriver to secure the front fender to the front fork.
5. Loosen and remove the bolts on the front fork tips with the Phillips screwdriver. Place them nearby.
6. Align the slots of the front fender stay with the holes on the front fork tips.

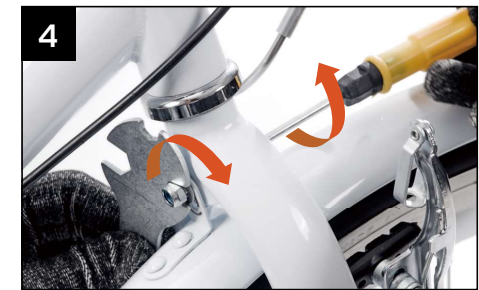

7. Replace and tighten the removed bolts with the Phillips screwdriver to secure the stay to the front fork.

8. Check that the pads on both brake arms are well aligned with the front wheel rim.

If they are not, loosen the locking bolts using the 5 mm hex wrench (16), correct such alignment for both pads, and retighten the bolts. **DO NOT** allow the brake pads to rub against the tire.

9. Reconnect the V-shaped front brake on the main frame's front fork, ensuring the cable is securely held in the clamp.

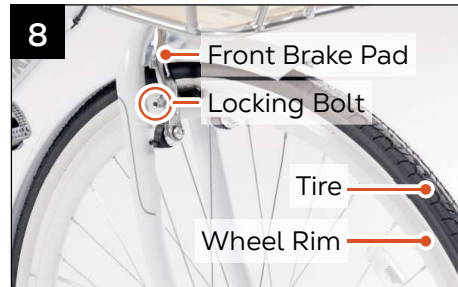

Installing the Rear Fender Stay

Parts and Tools

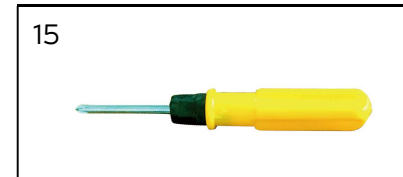

Steps

1. Use the Phillips screwdriver (15) to loosen and remove the two preinstalled bolts near the rear wheel axle.
2. Align the slots of the rear fender stay with the holes near the rear wheel axle.
3. Replace and tighten the removed bolts with the Phillips screwdriver to secure the stay.

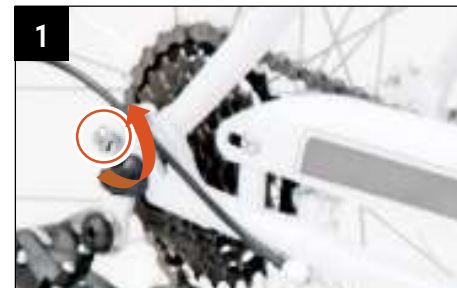

Installing the Rear Reflector and Rack

Parts and Tools



Steps

1. Use the multifunctional wrench (18) to loosen and remove the nut on the rear reflector (12) and attach the reflector to the hole on the rear rack (10) using its bolt.
2. Replace and tighten the nut with the multifunctional wrench to secure the rear reflector.
3. Use the Phillips screwdriver (15) to loosen and remove the preinstalled bolts near the seat tube. Place them nearby.
4. Align the front part of the rear rack with the holes near the seat tube in the position as shown.
5. Replace and tighten the removed bolts with the Phillips screwdriver to partly secure the rear rack.
6. Use the Phillips screwdriver to loosen and remove the remaining two preinstalled bolts near the rear wheel axle. Place them nearby.
7. Align the lower part of the rear rack with the holes near the rear wheel axle in the position as shown.
8. Replace and tighten the removed bolts with the Phillips screwdriver to fully secure the rear rack.

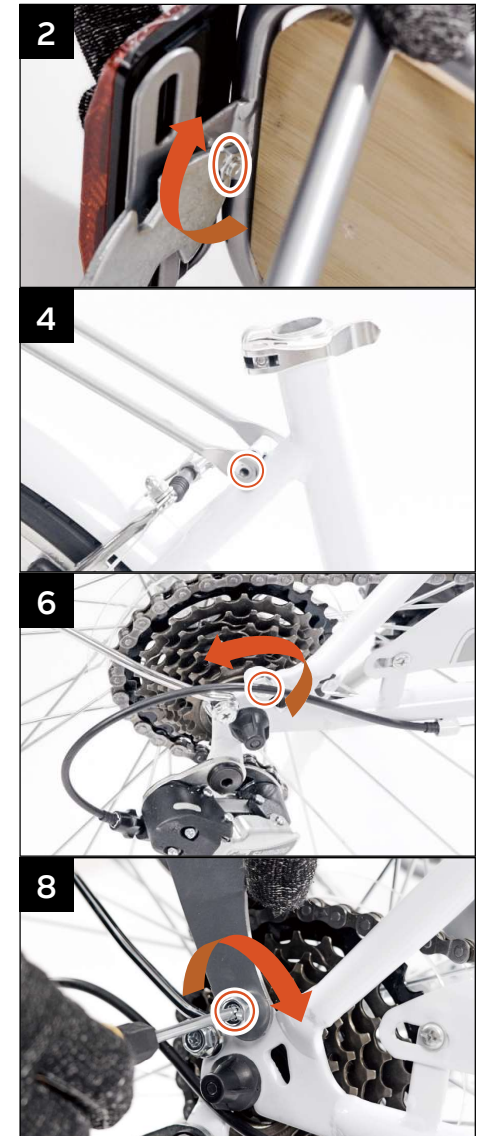

Installing the Front Basket

Parts and Tools

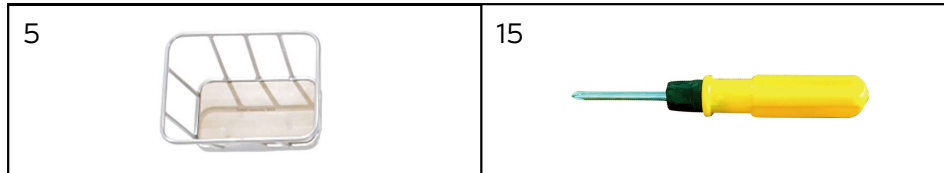

Steps

1. Use the Phillips screwdriver (15) to loosen and remove the preinstalled bolts on the mounting bracket.
2. Align the front basket (5) with the mounting bracket in the position as shown.
3. Replace and tighten the removed bolts with the Phillips screwdriver to secure the front basket.

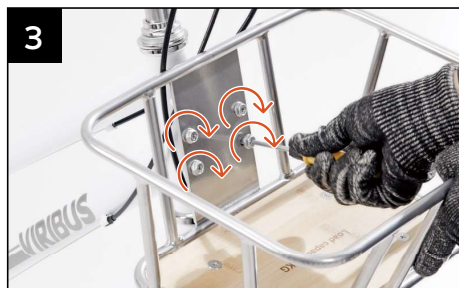

Installing the Saddle

Parts and Tools



Steps

1. Feed the saddle post (9) into the central hole underneath the saddle (8).
2. Tighten the locking nuts on both sides using the multifunctional wrench (18) until the saddle is securely fixed to its post.

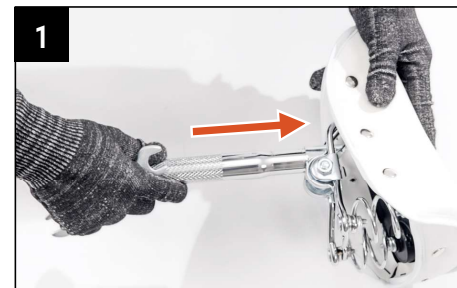

- Open the saddle clamp on the top of the seat tube using its locking handle.
- Insert the saddle post into the seat tube until your preferred height is reached and ensure that the saddle points a
- Close the saddle clamp by pressing its locking handle towards the seat tube.

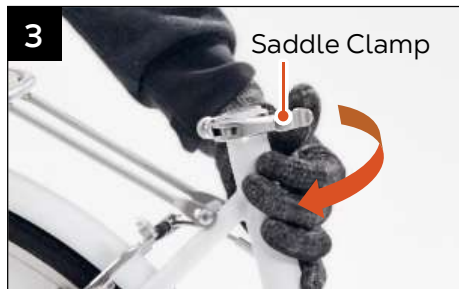

Installing the Pedals

Parts and Tools

6		18	
---	--	----	--

Steps

Note: Identify the separate pedals (6), which **ARE** different and should **NOT** be mixed up. The left pedal is marked with **L** and the right with **R**. The threads on the two pedals are opposite, twisting in the wrong direction may damage the pedal threads.

- Attach the pedals to the crank arms on the appropriate side, screwing them into place by hand.
- Tighten the locking nuts of the pedals with the multifunctional wrench (18) and test that the chain turns smoothly using the pedals, adjusting as needed.

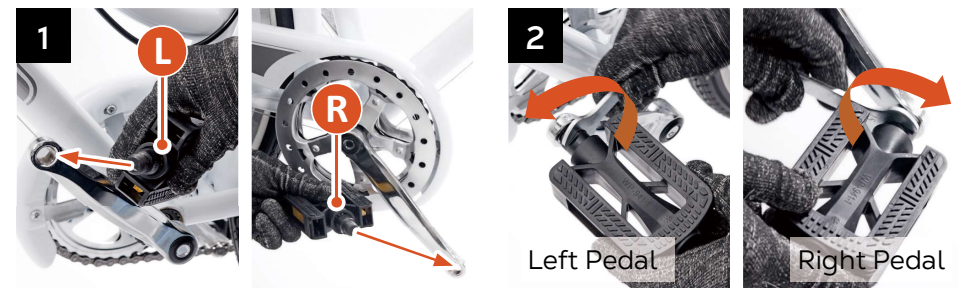

Installing the Bell

Parts and Tools

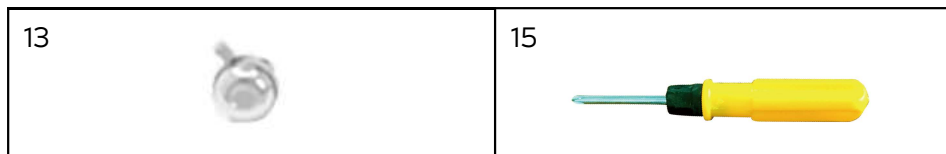

Steps

1. Unscrew the bolt from the clamp of the bell (13) with the Phillips screwdriver (15) and fit the bell onto a convenient place on the left handlebar using its clamp.
2. Replace and tighten the bolt with the screwdriver.

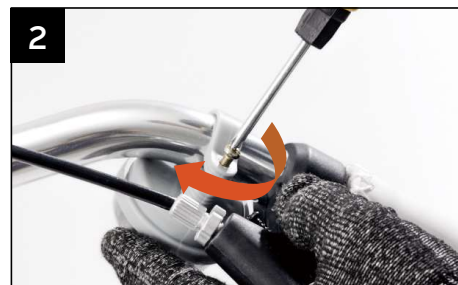
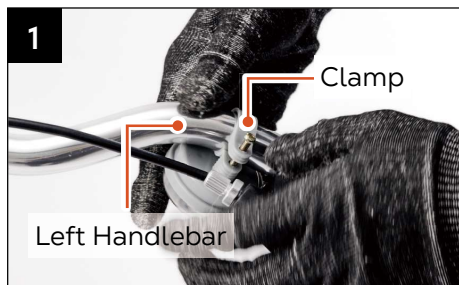

Installing the Front Reflector

Parts and Tools

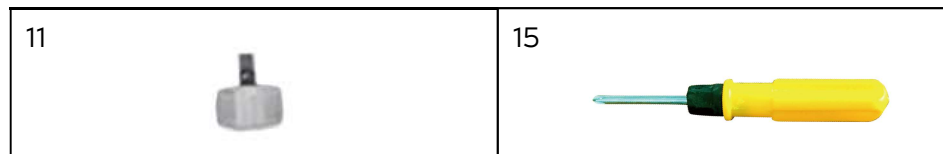

Steps

1. Unscrew the bolt from the clamp of the front reflector (11) with the Phillips screwdriver (15) and place the front reflector onto a convenient position on the handlebars using its clamp.
2. Replace and tighten the removed bolt with the screwdriver until the front reflector is locked into place.



Post-assembly Actions

Caution

Remember to take the following post-assembly actions to ensure optimal functionality for a safe and enjoyable riding experience. Failure to do so may result in unpleasant riding, property damage, and personal injury.

- Thoroughly check that **ALL** components and fasteners **ARE** undamaged and securely attached.
- Pay special attention to the frame connections, handlebars, chains, pedals, and wheels.
- Test smooth operation by rotating the wheels, steering, and pedaling.
- Make sure that **ALL** movements **ARE** fluid and free from any unusual resistance.
- Inspect the front and rear brakes by pressing their levers while pushing the bicycle forward.

Be sure that **BOTH** brake levers can effectively engage the brake systems, facilitating prompt and responsive deceleration and bringing the bicycle to a smooth and controlled stop.

Speed Gearing Adjustment

The Shimano thumb shifter on the right handlebar uses a lever and a button to control the 7 rear cogs, providing 7-speed gearing for manual riding.

Larger numbers represent smaller cogs and higher speeds.

Smaller numbers refer to larger cogs and lower speeds.

To upshift, press the + button at the base of the shifter.

To downshift, push away the lever beside the shifter.

Be sure that your bicycle's crank is turning while using the shifter to adjust the chain on the cogs.



Maintenance

- Check the parts of the bicycle for any looseness, wear, or damage after use. Tighten, repair, or replace any problematic parts before further use.

Warning

ONLY use identical replacements.

- The exterior of the bicycle can be cleaned with a soft damp cloth.

Caution

DO NOT use abrasive or caustic chemicals.

- Lubricate the chain and any moving part using a standard bike lubricant as needed.
- If the bicycle will not be used for an extended period of time, store in a cool dry place away from direct sunlight and inaccessible to children.

