

## Contact Us

Thank you for choosing our products! If you have any questions or comments, contact us at [support@viribusbikes.com](mailto:support@viribusbikes.com) and we'll resolve your issue ASAP!

For a .pdf copy of the latest version of these instructions, use the appropriate app on your smartphone to scan the QR code.



# Electric Tricycle

## User Manual

Read Carefully Before Use  
Keep for Future Reference



# Disclaimer

Read this disclaimer completely and carefully before proceeding with the rest of the manual content.

## 1. **As-Is**

This Viribus product is sold 'as is' and without any express or implied warranties, including but not limited to the implied warranties of merchantability and fitness for a particular purpose.

## 2. **Product Modifications**

Any modifications or alterations to Viribus products void any warranties and may result in damage or injury. Viribus shall not be liable for any damages resulting from such modifications or alterations.

## 3. **Compliance with Laws**

Customers shall be liable for ensuring that the use of Viribus products complies with all applicable laws and regulations in their respective jurisdictions. Viribus assumes no responsibility for any violations of laws or regulations resulting from the use of Viribus products.

## 4. **Correct Use**

Always use Viribus products only as directed in the accompanying manuals. Failure to follow instructions may result in injury or damage.

Always ensure the assembly, installation, operation, maintenance, or repair of Viribus products is carried out by a competent person.

Always make maintenance regularly throughout Viribus products' lifecycles; you have the liability to keep the products operating as intended.

Always wear appropriate protective gear.

## 5. **Third-Party Products**

Viribus shall not be liable for any damages or losses resulting from the use of third-party products in conjunction with Viribus products. Customers shall refer to the third-party's guidelines or/and warranties (if any) for any third-party products used.

## 6. **Limitation of Liability**

Viribus shall not be liable for any direct, indirect, punitive, incidental, special, or consequential damages to property or life, whatsoever arising out of or connected with the use or misuse of Viribus products. In no event shall Viribus's liability exceed the value of the products sold.

This disclaimer states the entire obligation of Viribus with respect to Viribus products. If any part of this disclaimer is determined to be void, invalid, unenforceable, or illegal, including but not limited to the warranty disclaimers, liability disclaimers, and liability limitations set forth above, the invalid or unenforceable provision will be deemed superseded by a valid and enforceable provision that most closely matches the intent of the original provision and the remainder of the agreement shall remain in full force and effect.

# Contents

<b>1. Safety Information</b> .....	<b>1</b>	5.7 Manual Control.....	27
1.1 General Notice.....	1	5.8 Navigation .....	28
1.2 Traffic Rules .....	1	<b>6. User-Defined Parameter Menus</b> .....	<b>29</b>
1.3 Clothing.....	1	6.1 General Guide.....	29
1.4 Safety Checks .....	2	6.2 Display Brightness.....	31
1.5 Sensible Use.....	2	6.3 Measurement Units.....	31
1.6 Electronic Components .....	3	6.4 Timed Shutoff .....	31
<b>2. Product Diagram</b> .....	<b>4</b>	6.5 Wheel Diameter .....	31
2.1 Package Contents.....	4	6.6 Speed Sensor.....	32
2.2 Overview.....	5	6.7 Top Speed.....	32
2.3 Display Panel.....	6	6.8 Throttle Start .....	32
<b>3. Specifications</b> .....	<b>7</b>	6.9 Disabling PAS or Throttle Control .....	32
<b>4. Assembly</b> .....	<b>7</b>	6.10 PAS Sensitivity.....	33
4.1 Installing the Handlebars .....	8	6.11 PAS Acceleration.....	33
4.2 Installing the Front Fender, Stay, and Light.....	9	6.12 PAS Sensor.....	33
4.3 Installing the Motorized Front Wheel.....	11	6.13 Resetting the Trip Odometer .....	33
4.4 Adjusting the Handlebars.....	13	6.14 Fault History .....	34
4.5 Installing the Rear Fenders and Stays.....	14	6.15 Bluetooth RSSI Level .....	34
4.6 Installing the Rear Basket .....	17	6.16 Battery Voltage.....	34
4.7 Installing the Saddle.....	20	6.17 Disabling Cruise Control.....	34
4.8 Installing the Pedals.....	22	6.18 Menu Languages .....	34
4.9 Post-Assembly Actions .....	23	6.19 Password Protection .....	35
<b>5. Operation</b> .....	<b>24</b>	6.20 Bluetooth Connection .....	37
5.1 Charging.....	24	6.21 System Version .....	38
5.2 Turning ON/OFF the Tricycle.....	25	6.22 Restoring the Factory Settings.....	38
5.3 Throttle Control.....	25	<b>7. Technician-Defined Issues</b> .....	<b>39</b>
5.4 Pedal Assist Control .....	26	<b>8. Maintenance</b> .....	<b>40</b>
5.5 Cruise Control.....	26	<b>9. Troubleshooting</b> .....	<b>41</b>
5.6 Push Assist Control.....	27	<b>10. Disposal</b> .....	<b>42</b>



# 1. Safety Information

## Warning

### 1.1 General Notice

- Read **ALL** these instructions completely prior to assembly and use.  
Contact customer service if any point is unclear.
- Provide this manual to anyone who will use this tricycle and provide it with this tricycle (whether already assembled or not) if it is ever given or sold to a third party.
- **ONLY** assemble and use this tricycle in accordance with these instructions.  
Failure to do so may lead to serious property damage and severe personal injury.

### 1.2 Traffic Rules

- **ALWAYS** obey **ALL** applicable local and national laws and regulations while riding.
- **DO NOT** allow use by children, by persons unfamiliar with this tricycle or these instructions, or by anyone whose physical or mental impairment precludes safe use.
- **DO NOT** ride this tricycle while tired or under the influence of drugs or medication.
- **DO NOT** ride this tricycle in **ANY** area prohibited to electric tricycles.
- **ALWAYS** maintain your reflectors and other required safety equipment.
- It is advisable to equip your tricycle with a warning device such as a horn, bell, and light in case you are riding at times of poor visibility.  
This is **EVEN** required in some jurisdictions.

### 1.3 Clothing

- **ALWAYS** wear appropriate hand protection during assembly, disassembly, adjustment, or repair of this tricycle.
- **DO NOT** wear loose footwear or clothing that may become caught in the wheels or any other moving parts while riding.
- **DO NOT** ride this tricycle with bare feet.  
**ALWAYS** wear closed-toe shoes with good traction to maintain grip on the pedals and provide protection for your feet.
- **ALWAYS** wear a helmet and other required protective gear that meet safety standards while riding.
- Gloves with grip padding are strongly recommended for riding.  
They can strengthen your hold on the handlebars and protect your hands in case of a fall.
- Wear sunglasses or other clear protective eyewear to shield your eyes from dust, debris, and insects.
- In sunny conditions, it is advisable to apply sunscreen to exposed skin, especially for long rides.
- For best results, choose brightly colored or reflective clothing or attach reflective accessories or strips to your clothing to enhance visibility from all angles, especially during low-light conditions.

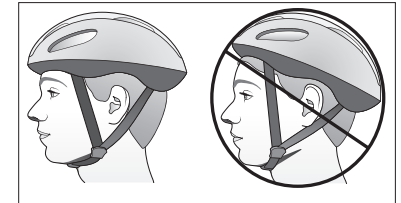

## 1.4 Safety Checks

- **ALWAYS** check that **BOTH** the front and rear brakes are positioned properly **BEFORE** riding.

Even when power is cut to the motor, the inertia of the tricycle will often require active braking power.

- **ALWAYS** check that **ALL** components and fasteners are intact and securely tightened **BEFORE** and **AFTER** riding.
- Regularly check the reflectors to make sure that they are clean, straight, unbroken, and securely mounted. Also perform this check for the front light.

Riding with low light or without lights or reflectors is **EXTREMELY** dangerous.

- **DO NOT** ride this tricycle if any part is damaged or shows any sign of malfunction.

Repair or replace worn and broken components before further use, especially bent or broken spokes and wheel rims.

- **NEVER** replace any components or fasteners with nonidentical ones.

## 1.5 Sensible Use

- **ONLY** allow one person to use this tricycle at a time.
- **DO NOT** carry children in the rear basket while riding.

If carrying pets, ensure that this act is permitted in your jurisdiction and they are safely secured with comfort.

- **NEVER** ride at a speed where your stopping distance exceeds your visibility.
- For optimal safety, it is **NOT** recommended to ride your tricycle at night or in environments with poor visibility (e.g., foggy or snowy conditions).

If you have an emergency that makes it necessary to do so, keep your light on and limit your speed appropriately.

- It is recommended that you **NOT** ride your tricycle fast **UNTIL** you are **FULLY** familiar with this new electric tricycle and its controls.

**HOWEVER**, even when you are familiar with the tricycle, **ALWAYS** be mindful of your speed, ensuring that you have sufficient room to brake in an emergency.

- **DO NOT** ride this tricycle in extreme weather conditions, such as thunderstorms and hurricanes.

If you meet with them during a ride, stop your tricycle, find a safe shelter, and wait until they pass.

- When meeting a strong wind, keep a firm grip on the handlebars, lean into the wind, and adjust your position as needed to maintain control.

- In wet weather, be careful to avoid sharp turns, which are easy to cause an accidental fall.

- **ALWAYS** be alert for people, animals, or any obstacles that may appear in front of you while riding your tricycle.

**ALWAYS** be careful of passing parked cars, whose doors might open suddenly.

**ALWAYS** be aware that pedestrians and drivers may not expect the speed or responsiveness of your tricycle. Adjust your behavior accordingly.

It is advisable to install warning devices to draw their attention, **BUT** always be ready to turn safely out of their way if needed.

- **ALWAYS** be careful at road and rail crossings.

Slow down and check both ways for oncoming traffic.

- **DO NOT** ride this tricycle in close proximity to precipices or on highly uneven, sandy, or sloped surfaces.



- **DO NOT** push backward on the pedals when using the gear shifter.  
Otherwise, the chain may get stuck, causing serious damage to this tricycle.
- **DO NOT** carry packages or objects on your tricycle in a way that obstructs your view of the road.
- **DO NOT** leave the rear basket door open when carrying things during a ride.
- **DO NOT** load this tricycle with more than 395 pounds (180 kg), including 110 pounds (50 kg) in the rear basket.
- **DO NOT** use harsh abrasives or caustic chemicals to maintain this tricycle.
- When inflating the wheel tires, **DO NOT** exceed 30 psi (2 bar or 200 kPa).
- For best results, place this tricycle in locations inaccessible to children after use.  
Otherwise, provide constant supervision to prevent accidents.

## 1.6 Electronic Components

- **NEVER** use the throttle, PAS, cruise, or push assist control in any situation, road condition, or terrain where doing so might impair your control of this tricycle.
- **NEVER** use the display panel to adjust the default settings in **Wheel Size**, **Steel Num**, **Boost Magnetic Type**, or **Voltage Level** menu at random or without any professional guidance.
- **NEVER** operate the technician-defined menus in the **Factory Mode** directory randomly on your own.
- **DO NOT** deactivate the display panel by directly removing the battery, as such an abrupt power cut may damage the components or shorten their lifespans.
- **DO NOT** disassemble the display panel or modify its internal components.
- **DO NOT** disassemble the controller or modify any preconnected wiring.
- **ALWAYS** avoid direct pressurized spray that might allow the interior of the battery, display panel, front light, and other electronic components to become wet.  
If the interior of the battery accidentally becomes wet, replace it with a new identical one. For the other electronic parts, wait for them to completely dry before any further use.
- **DO NOT** focus on the display panel for prolonged periods of time while riding.
- **ALWAYS** turn off the display panel between uses.  
If necessary, remove the battery to prevent unauthorized use.
- **DO NOT** leave the display panel on when undertaking maintenance or repair.  
Failure to do so may lead to unintentional start of the motorized front wheel, posing a series of safety hazards.
- For best results, remove the battery **FULLY** from this tricycle **BEFORE** performing any cleaning, servicing, and storage.
- **NEVER** place the battery near heat sources or explosive or flammable gases.
- **NEVER** expose the battery to radiation or excessive pressure.
- **ONLY** charge the battery in locations with an ambient temperature between 32° and 113°F (0–45°C).
- **NEVER** disassemble or modify the battery.
- **ONLY** use the provided charger with the battery.
- **NEVER** get the charger wet or operate it with wet hands.
- If the battery is ever damaged, avoid **ALL** contact with it or any leaking fluid. Remove contaminated clothing and flush with copious amounts of water if contact accidentally occurs with the skin.  
If contact accidentally occurs with the eyes, **IMMEDIATELY** flush them with copious amounts of water for at least 15 minutes while seeking medical attention.

## 2. Product Diagram

### 2.1 Package Contents

#### Important

When you first receive your new tricycle, carefully unpack all these items and check that nothing is missing or has been damaged in transit. If necessary, ask your local dealer or contractor for supplements or replacements.

Besides, storing your original packaging through the warranty period will speed returns if any are needed.

#### Main Parts



Item	Name	Qty.
1	Rear Basket	1
2	Rear Fenders	2
3	Rear Fender Stays	2
4	Saddle	1
5	Tricycle Frame	1
6	Left Pedal (L)	1
7	Right Pedal (R)	1
8	Collar	1
9	Handlebars	1
10	Front Light	1
11	Front Fender Stay	1
12	Front Fender	1
13	Motorized Front Wheel	1
A	Charger	1
B	Keys	2
C	Phillips Screwdriver	1
D	M5 Hex Wrench	1
E	M6 Hex Wrench	1
F	M8×10 Wrench	1
G	M15 Wrench	1
H	M18 Wrench	1

#### Tools

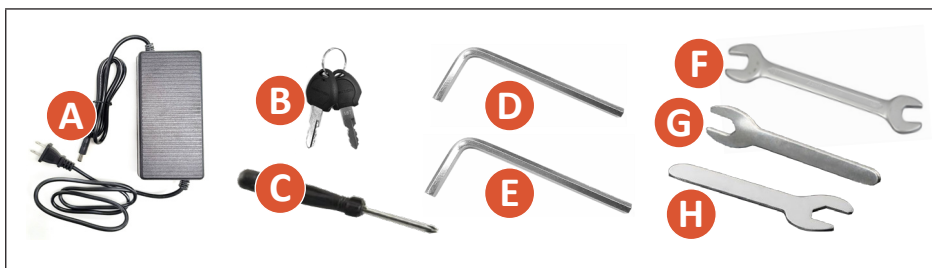

#### Not Included but Helpful

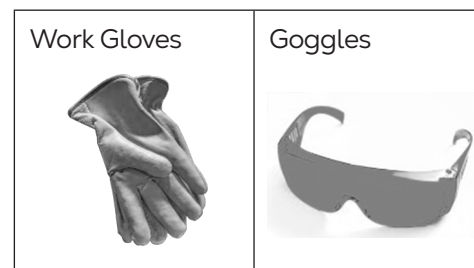



## 2.2 Overview

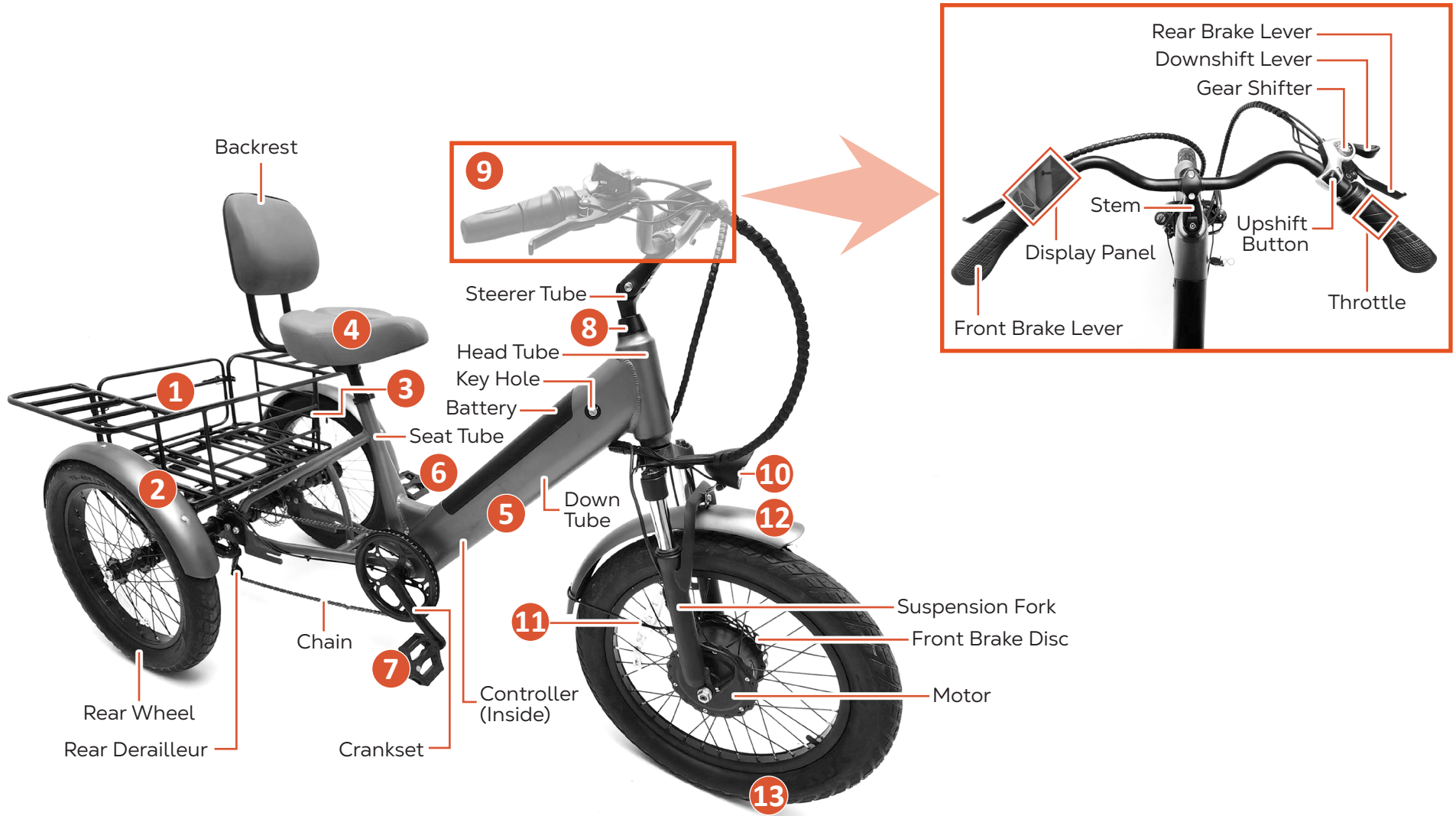



## 2.3 Display Panel

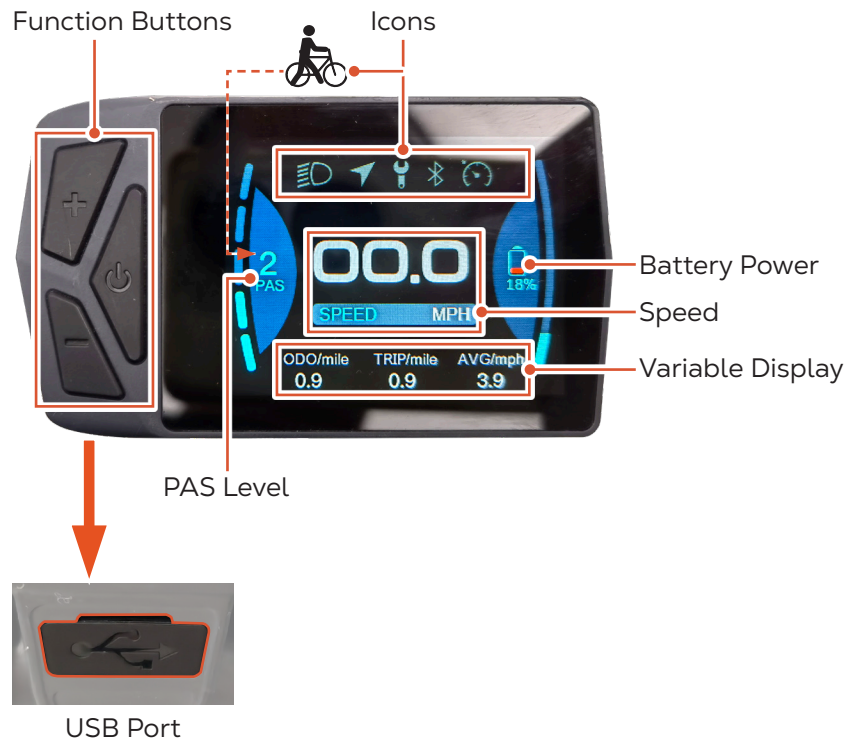

Function Buttons	⏻	Confirms settings adjustment when pressed. Turns on/off the display panel when held.
	+	Increases the pedal assist level when pressed. Turns on/off the front light when held.
	-	Decreases the pedal assist level when pressed. Activates cruise or push assist control when held.
Display Areas	Battery Power	Shows the remaining battery power level (0 to 100%).
	PAS Level	Shows the current pedal assist level (0 to 5).
	Speed	Shows the current speed in mph or km/h.
	Variable Display	Shows your total distance traveled (ODO), current trip distance (TRIP), and average speed of the current trip (AVG).
Icons	☰	Indicates the front light is on.
	➤	Indicates navigation is operating.
	⚠	Indicates system errors.
	📶	Indicates Bluetooth is operating.
	🕒	Indicates cruise control is operating.
	🚲	Indicates push assist control is operating.
USB Port		Charges mobile devices through a type C cable (not included).



### 3. Specifications

Motor Power		500 W	
Display Panel	Screen Type	Liquid Crystal Display (LCD)	
	USB Port	Type C	
	Weatherproof Rating	IPX6	
Front Light Weatherproof Rating		IPX5	
Battery	Type	48 V Lithium	
	Weatherproof Rating	IPX6	
	Operational Temp.	-4 to 140°F	-20 to 60°C
	Charging Temp.	32 to 113°F	0 to 45°C
	Optimal Storage Temp.	50 to 86°F	10 to 30°C
Weight Capacity	Rear Basket	110 lb.	50 kg
	Total	395 lb.	180 kg
Rider Height Range		5.3 to 6 ft.	160 to 185 cm
Max. Speed		20 mph <sup>(1)</sup>	32 km/h <sup>(1)</sup>
Max. Travel	Throttle Control	38 mi. <sup>(2)</sup>	61 km <sup>(2)</sup>
	PAS Control	65 mi. <sup>(2)</sup>	105 km <sup>(2)</sup>
Tires	Pressure	30 psi	2 bar (200 kPa)
	Type	20×3.0 in.	

(1) Based on unloaded wheel rotation at full power without friction

True maximum speed will vary according to variables such as battery strength and load but should remain  $\pm 1$  mph of the preset value.

(2) Based on a 165 lb. or 75 kg load at full power and full legal speed on actual roads

### 4. Assembly

#### Warning

To ensure optimal safety, be sure to fulfill the following conditions during assembly.

- Keep your work area clean and well-lit. Cluttered or dark areas invite accidents.
- Wear hand and eye protection to prevent accidents. Work gloves and goggles (not included) are strongly recommended. If necessary, ask one or more persons for assistance **BUT** remember to have everyone wear equivalent personal protective equipment.
- **DO NOT** allow children or pets to play with **ANY** tricycle parts, tools, or packaging materials. Provide constant supervision or restrict access to your work area as needed.
- **DO NOT** turn on the display panel. For best results, remove the battery from the tricycle frame before starting your work.

#### Important

To see these instructions in video form, go to our **YouTube** channel **Viribus Workshop** and search for "**ABE-F**".

## 4.1 Installing the Handlebars

### Parts



### Steps

1

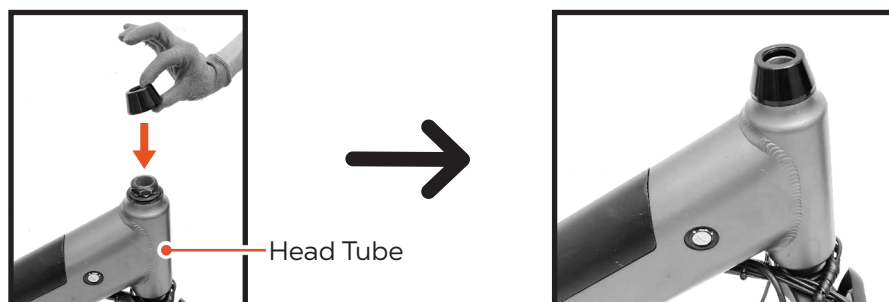

- Fit the collar (8) to the hole at the top of the head tube on the tricycle frame (5).
- Fine-tune the collar until it is properly seated around the hole.

2

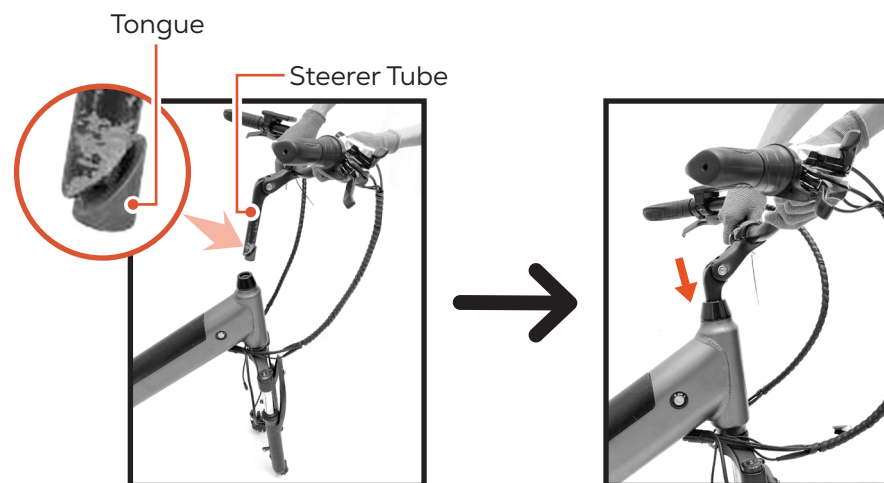

- Ensure the tongue remains loose and correctly positioned.
- Insert the steerer tube into the head tube, pressing down on the handlebars (9) until they sit firmly.

### Warning

*Exercise caution with the steerer tube to prevent personal injury.*

## 4.2 Installing the Front Fender, Stay, and Light

### Parts and Tools

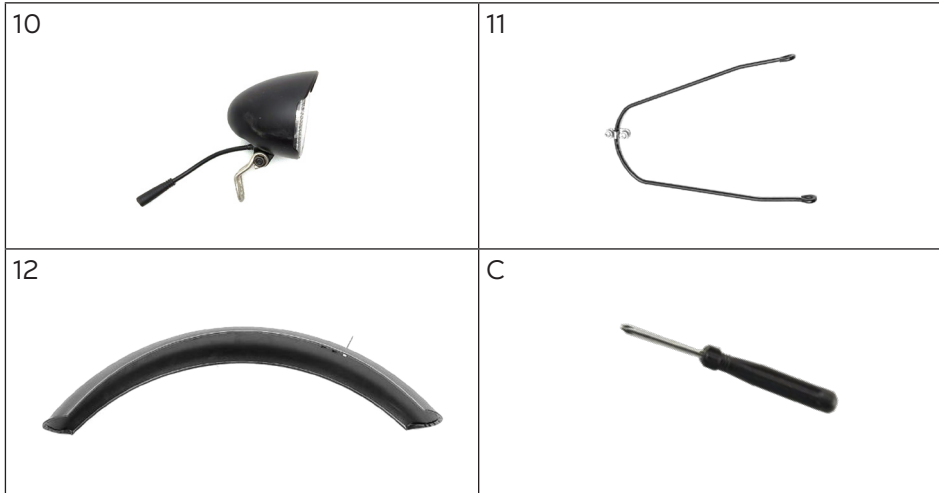

### Connecting the Front Fender Stay to the Front Fender

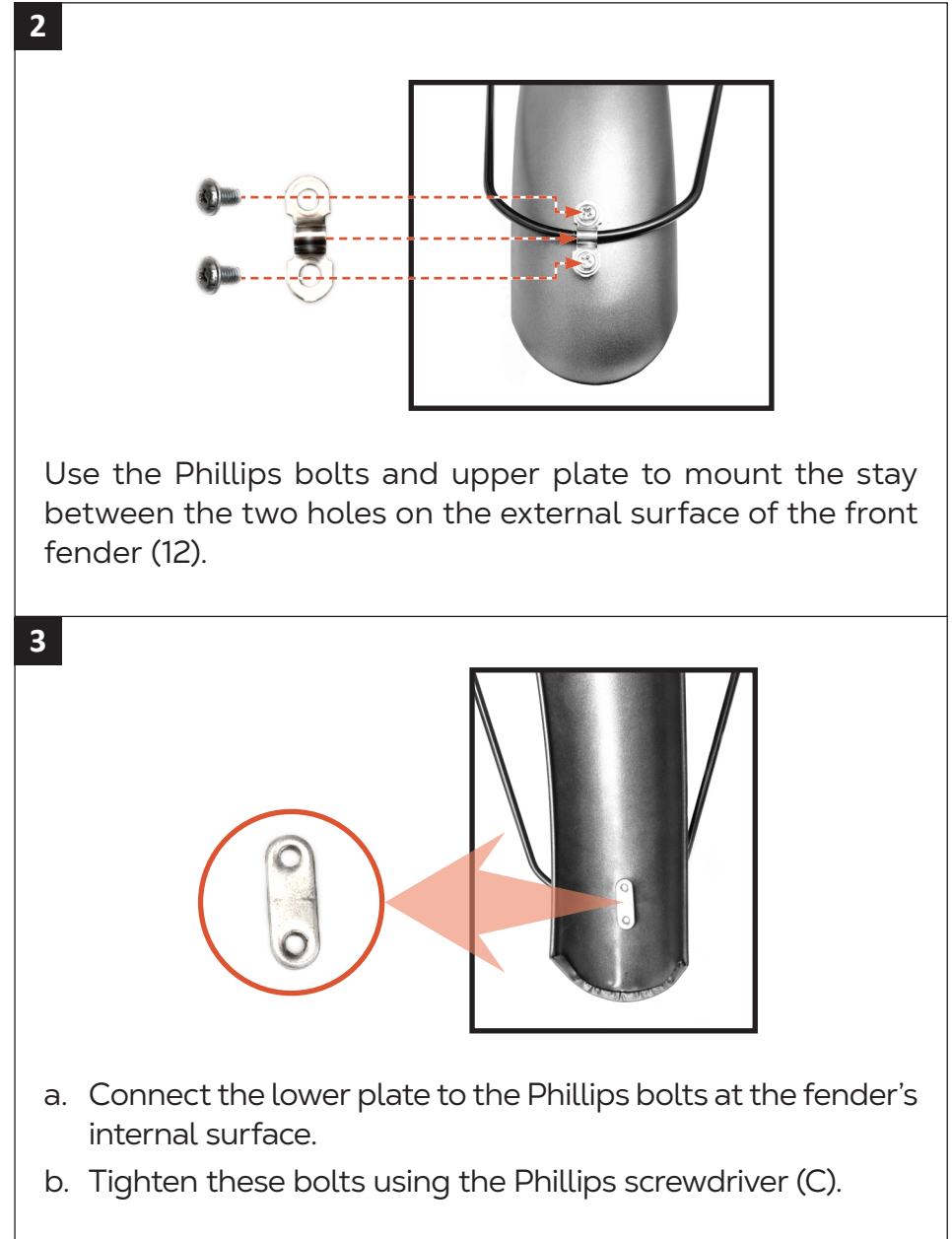
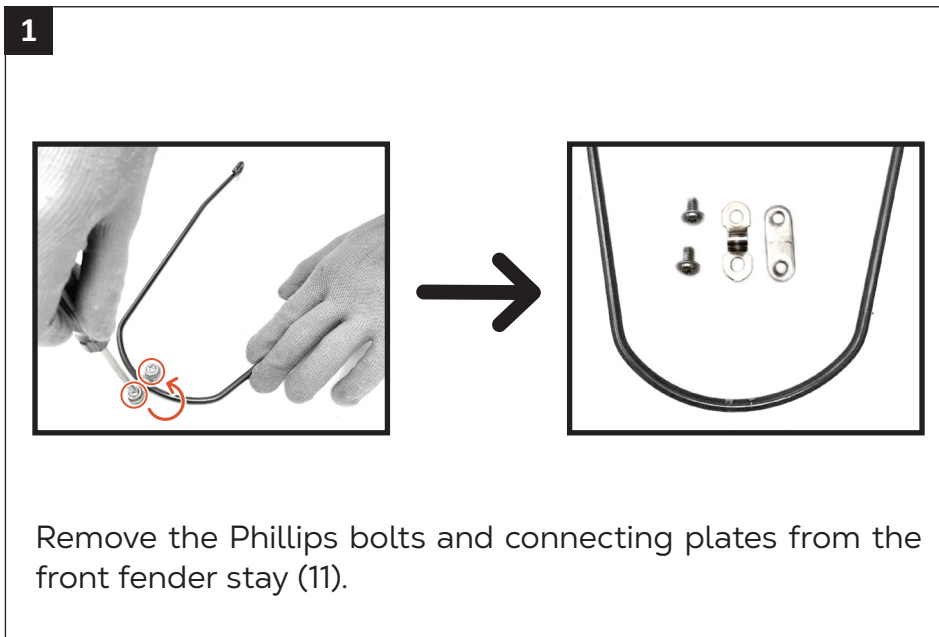

## Connecting the Front Fender and Light to the Suspension Fork

1

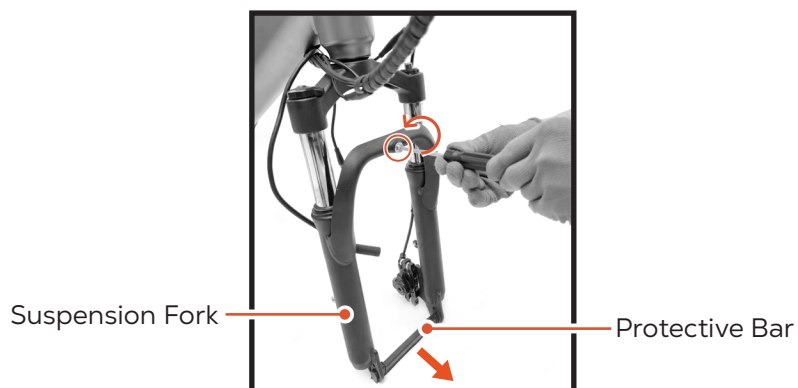

Remove the Phillips bolt and protective bar from the suspension fork.

2



Position the front fender and light (10) against the bolt hole.

- Ensure their slots are well aligned with the hole as shown.

3

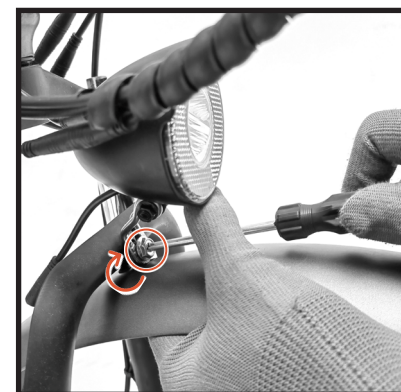

Replace and tighten the Phillips bolt to secure the fender and light into place.

4

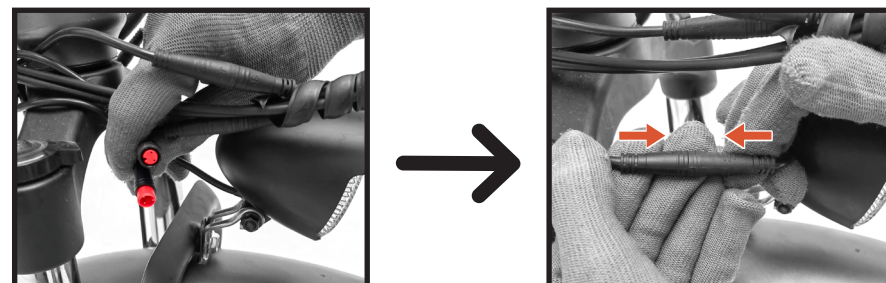

Connect the red-banded wires for the front light.

### Connecting the Front Fender Stay to the Suspension Fork

1

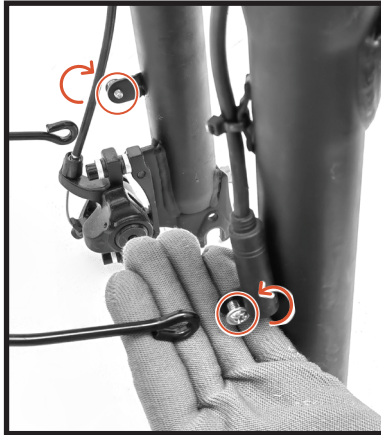

Remove the Phillips bolts from both sides of the suspension fork.

2

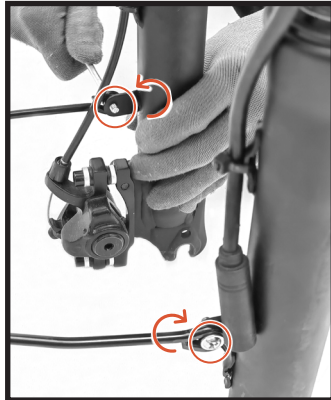

- a. Align the front fender stay with the bolt holes left on the fork.
- b. Replace and tighten the bolts to secure the stay into place.

### 4.3 Installing the Motorized Front Wheel

#### Part and Tool

13



H

M18



#### Steps

1

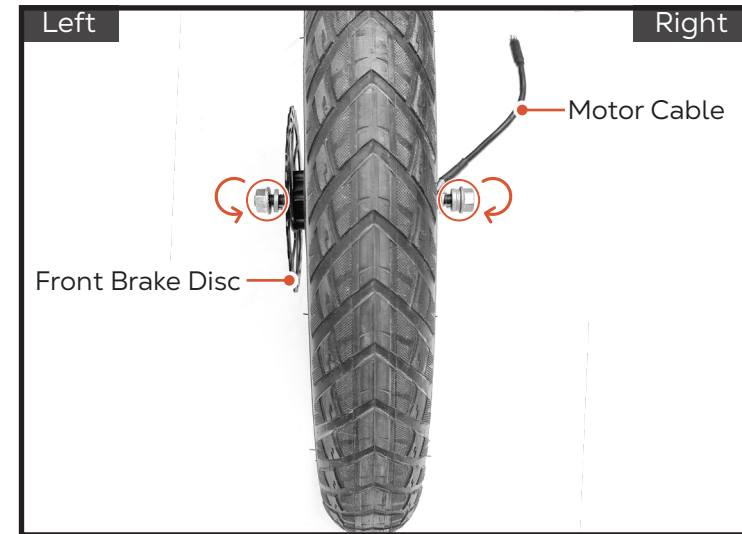

Prepare the motorized front wheel (13).

- Place the brake disc at the left side and the motor cable at the right.
- Ensure that both nuts at the wheel hub are loose.

2

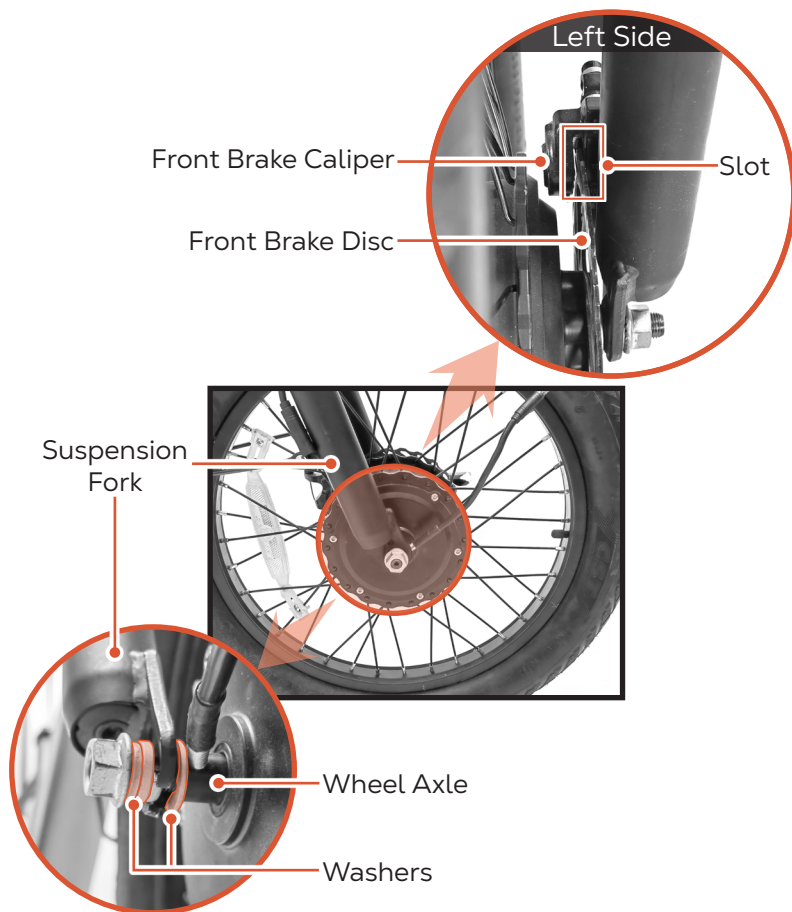

Fit the front wheel into the suspension fork.

- Allow the wheel axle to be correctly and snugly held by the fork tips.
- Ensure the brake disc is well fitted into the slot of the front brake caliper.

3

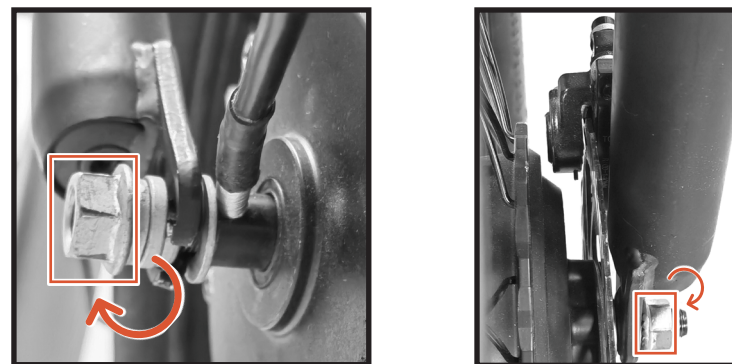

Tighten the nuts at both sides using the M18 wrench (H).

4

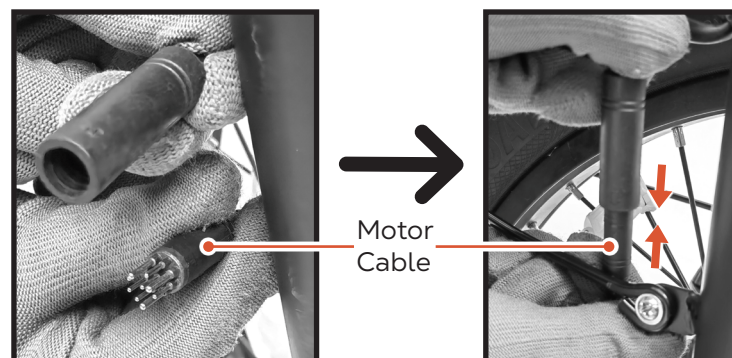

Connect the motor cable to the appropriate plug at the same side.

**⚠ Warning**

Ensure that the display panel remains **OFF**.

## 4.4 Adjusting the Handlebars

### Tool



### Steps

1

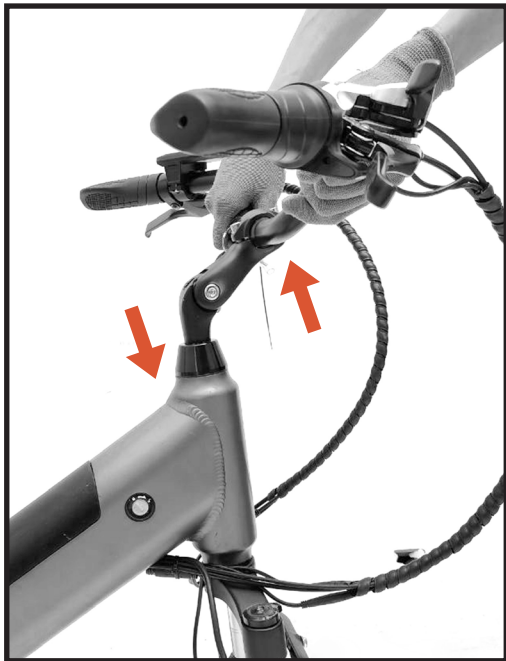

Raise or lower the handlebars until your preferred height is reached.

2

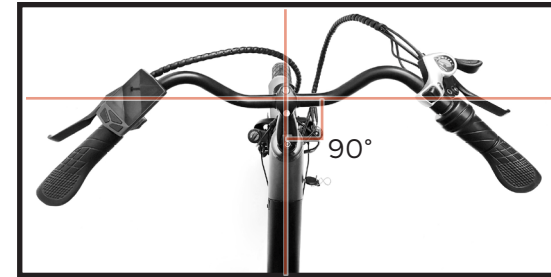

Rotate the handlebars until they become perpendicular to the down tube.

3

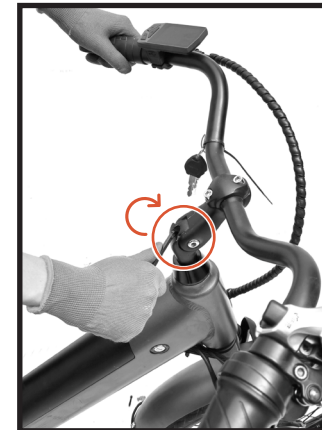

- a. Tighten the bolt at the top of the steerer tube using the M6 hex wrench (E).
- b. Check that the handlebars turn the front wheel left and right smoothly.



## 4.5 Installing the Rear Fenders and Stays

### Parts and Tools

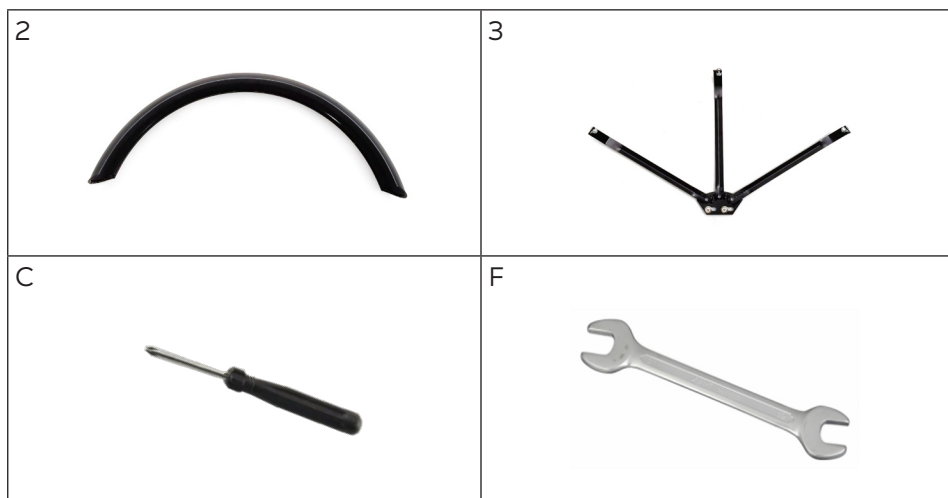

### Connecting the Rear Fender Stays to the Rear Fenders

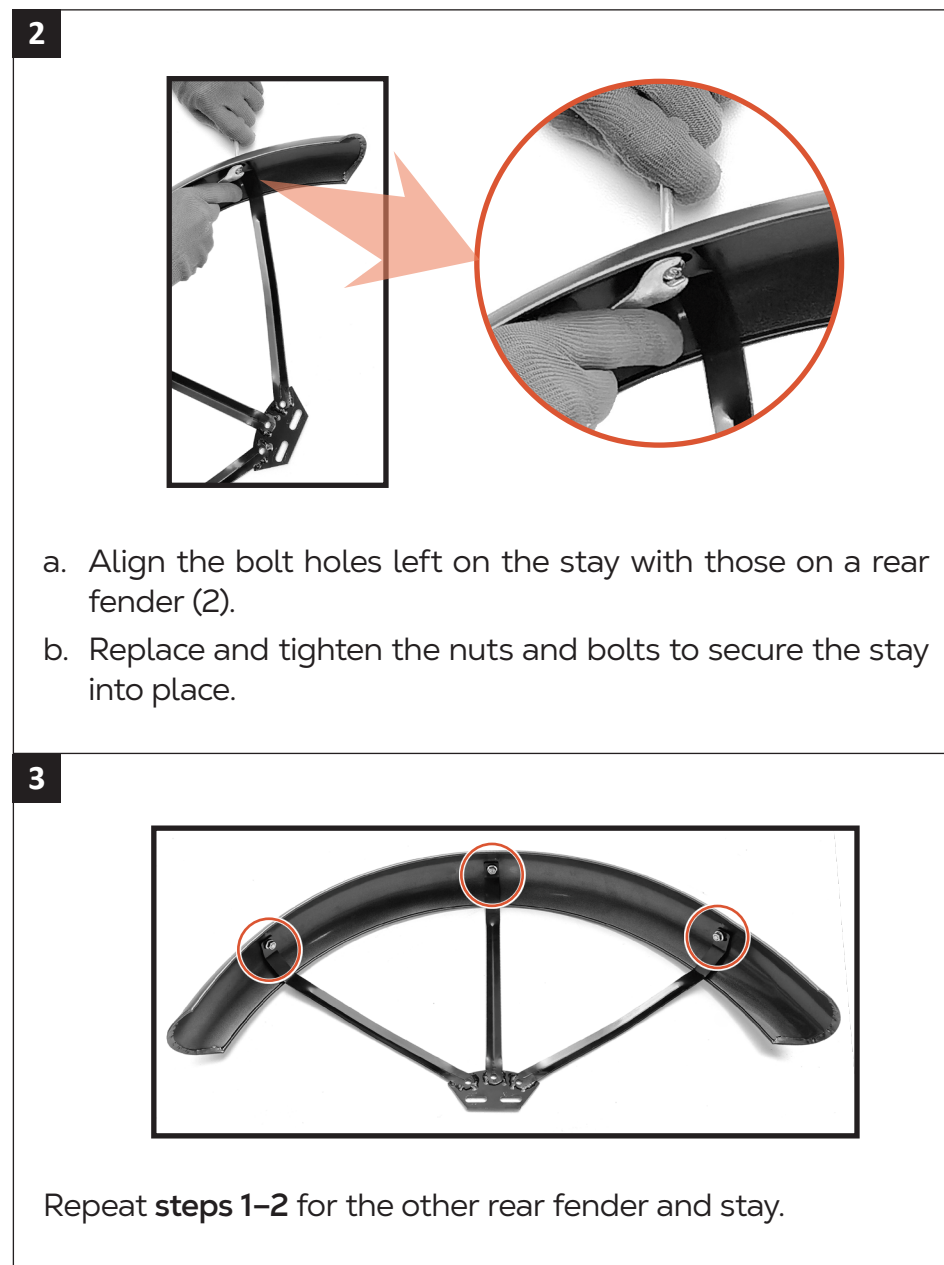
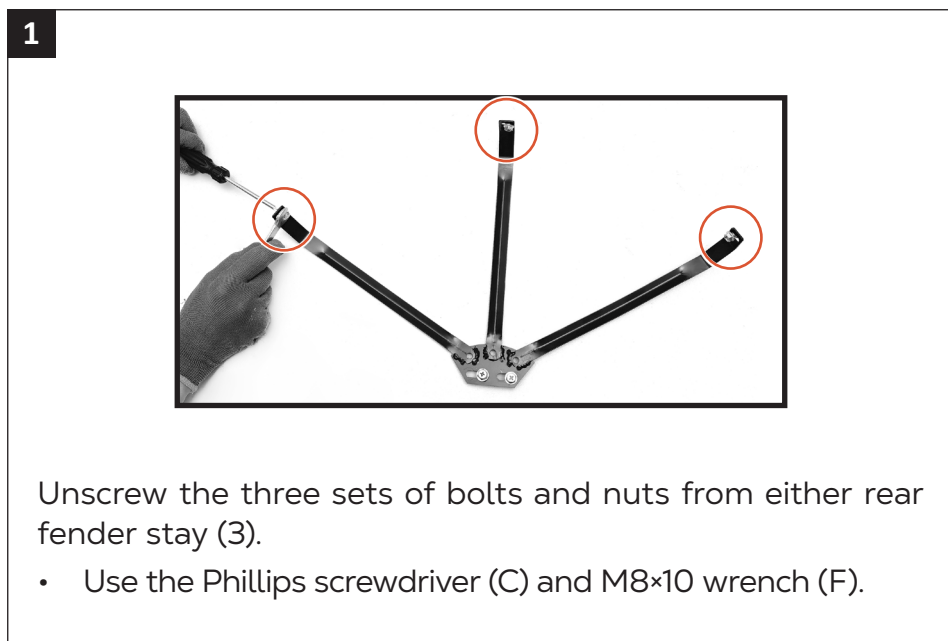

## Connecting the Rear Fender Stays to the Tricycle Frame

1

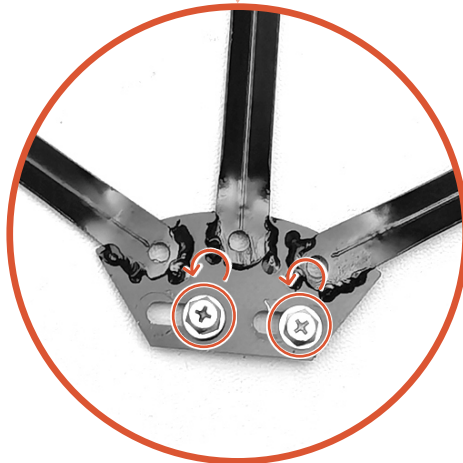
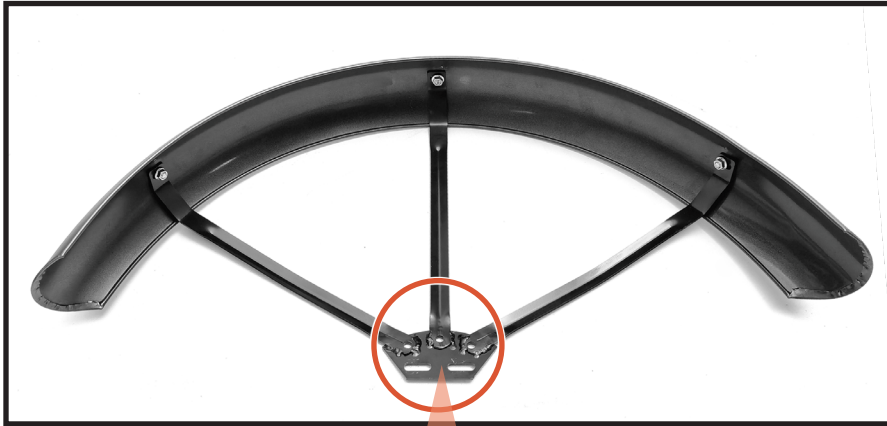

Remove the two sets of nuts and bolts from either rear fender stay.

2

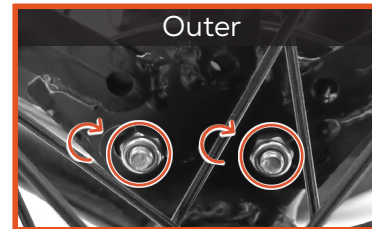
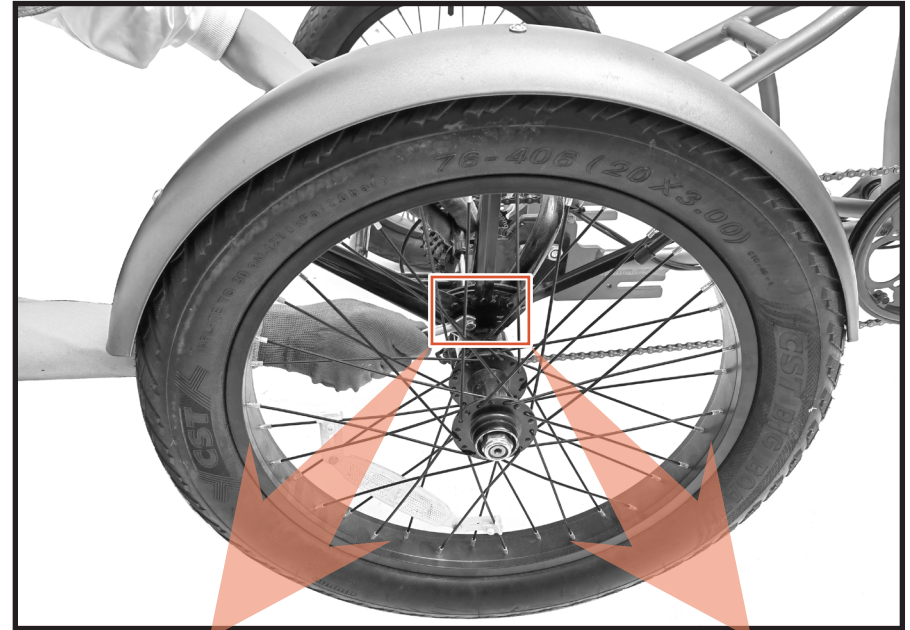

- Place the corresponding rear fender above the rear wheel at the appropriate side.
- Align the fender stay with the fan-shaped bracket on the tricycle frame.
- Replace and tighten the bolts and nuts to secure the stay to the frame.

1

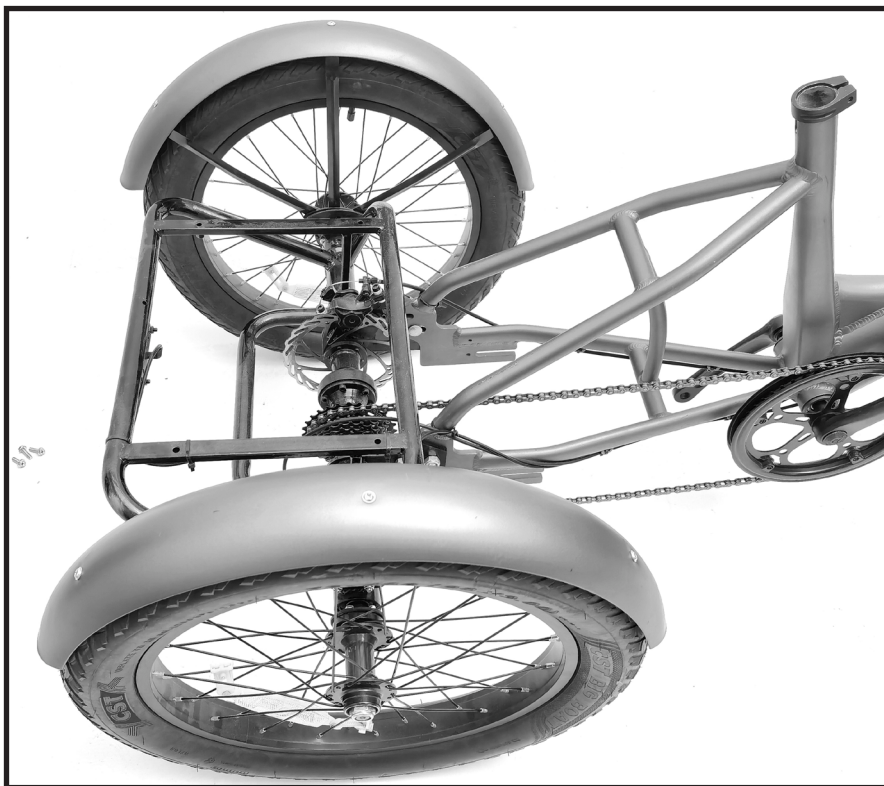

Install the other rear fender and stay on the tricycle frame in the same fashion.

**Important**

*Grasp the handlebars and push forward the tricycle frame. Test that **NONE** of the wheels are rubbing against the fenders.*



## 4.6 Installing the Rear Basket

### Part and Tools

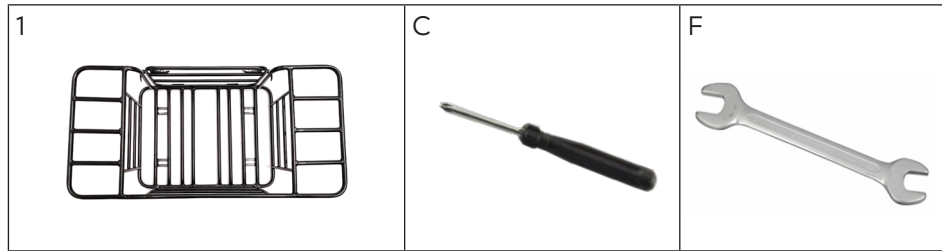

### Steps

**1**

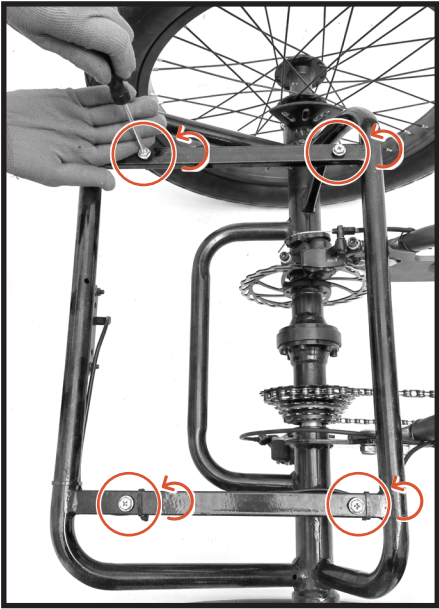

Remove the four sets of bolts and nuts from the frame between the rear wheels.

- Use the Phillips screwdriver (C) and M8×10 wrench (F).

**2**

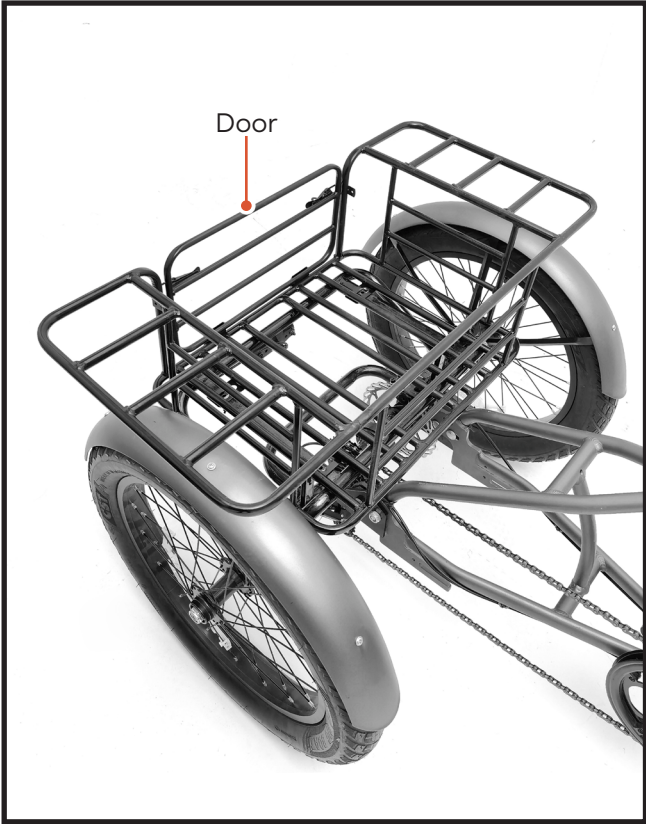

Fit the rear basket (1) onto the frame.

- Place the basket door at the rear side.

3

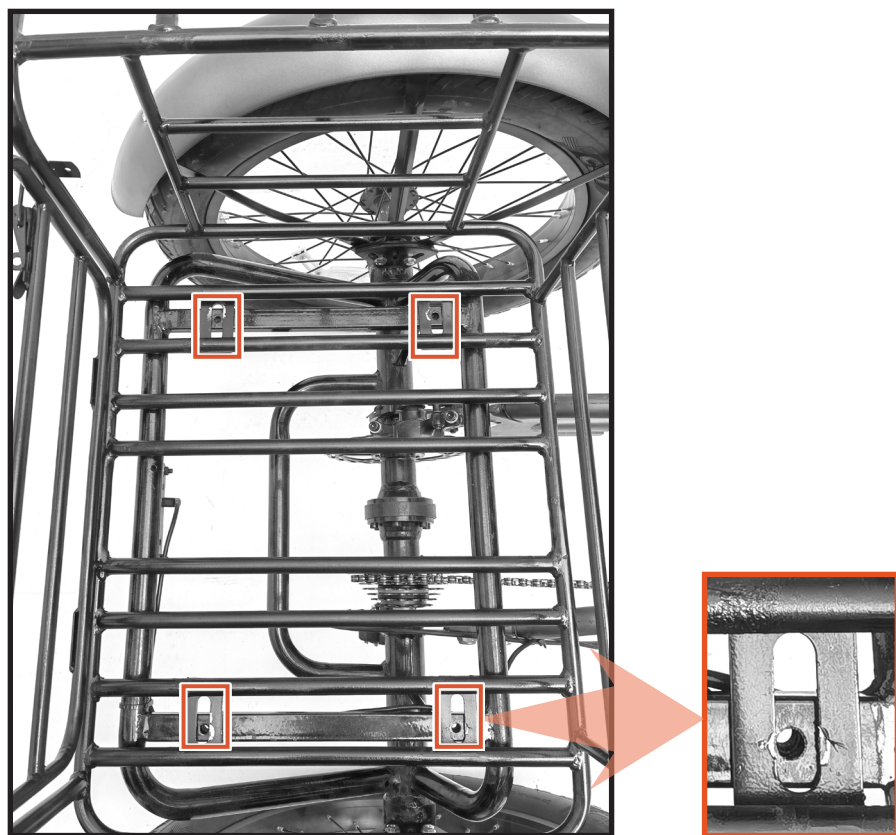

Align the basket's bottom slot with the bolt holes left on the frame as shown.

4

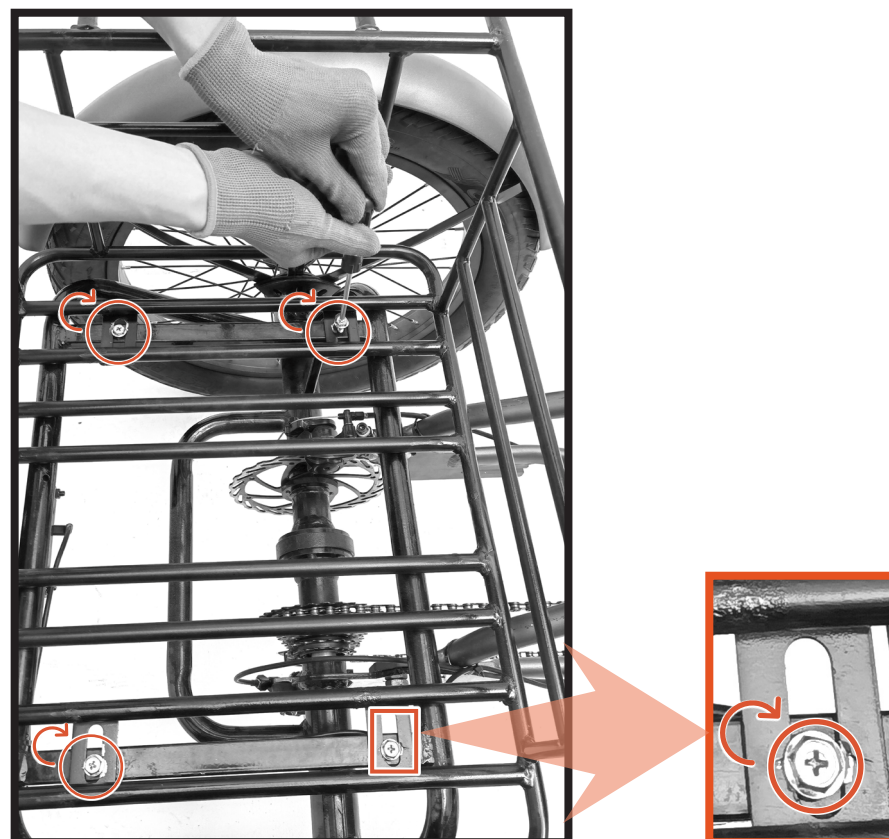

Replace and tighten the bolts and nuts to secure the basket into place.

## Opening the Rear Basket (Optional)

1

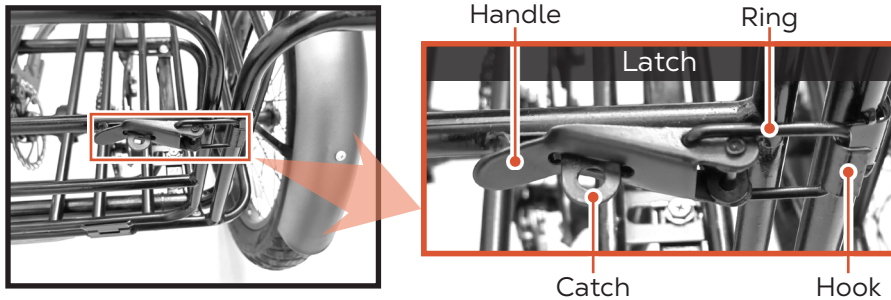

Locate the latches at the left and right sides of the basket door.

2

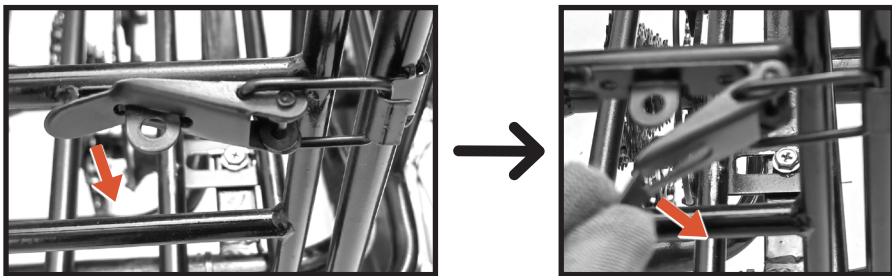

Pull the slotted handles away from the catches.

3

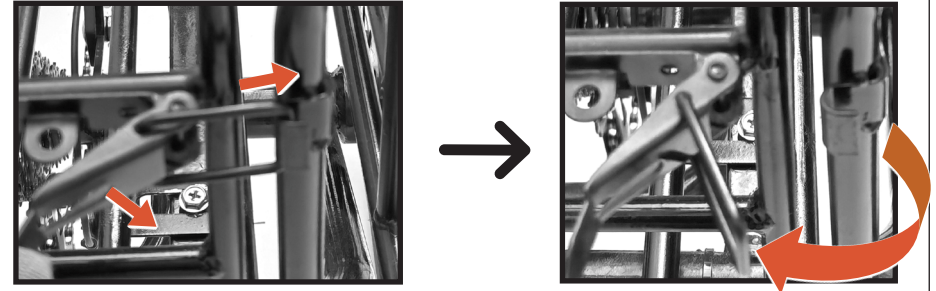

- Continue to pull the handles, pushing the rings out of the hooks.
- Rotate the rings as shown, fully releasing the latches.

4



**⚠ Caution**

*DO NOT* leave the door open when carrying things during a ride.

Open the door.

- To close it, reverse the actions and steps.

## 4.7 Installing the Saddle

### Part and Tools

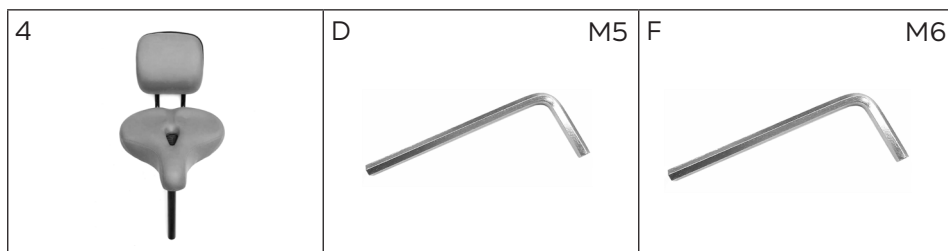

### Steps

**1**



Insert the post of the saddle (4) into the seat tube until your desired height is reached.

**2**

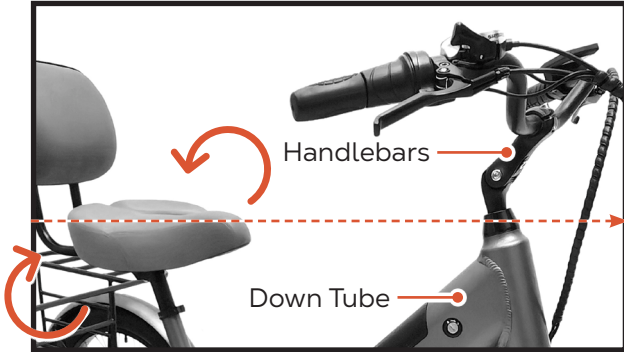

Rotate the saddle until it points at the handlebars and aligns with the down tube.

**3**

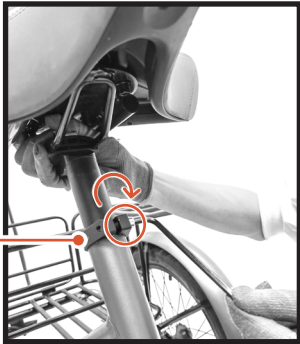

Tighten the clamp bolt at the top of the seat tube to secure the saddle into place.

- Use the M5 hex wrench (D).

## Fine-Tuning (Optional)

### Backrest

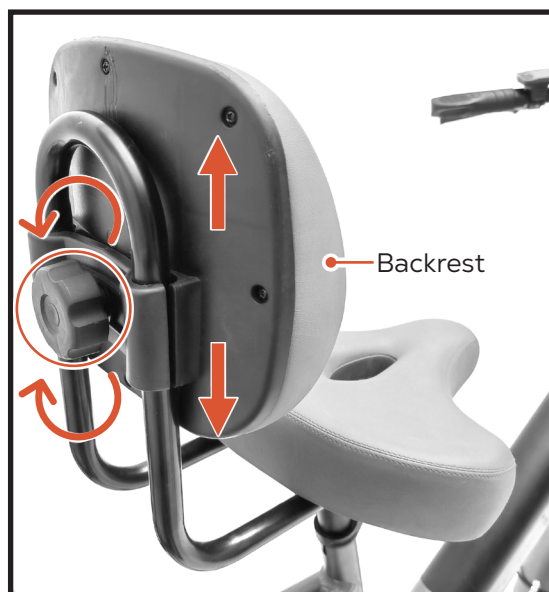

1. Loosen the locking knob behind the backrest.
2. Slide the backrest up or down on its support frame until it reaches your preferred height.
3. Retighten the knob to lock the backrest in place.

### Seat Cushion

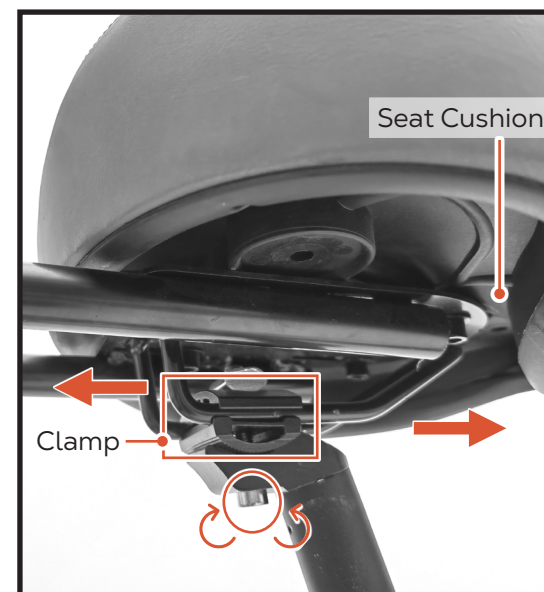

1. Loosen the clamp bolt underneath the saddle.
2. Slide the seat cushion's support frame forward or backward within the clamp.
3. Retighten the bolt to lock the cushion in place.
  - Use the M6 hex wrench (E).



## 4.8 Installing the Pedals

### Parts and Tool



**Note:** The two pedals **ARE** different and **NOT** interchangeable.

### Steps

**1**

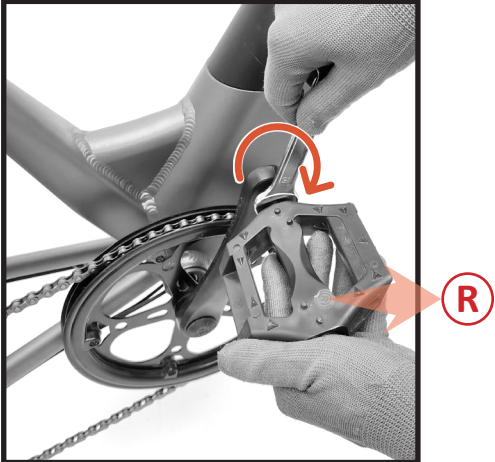

- Attach the pedal labeled **R** (7) to the crank arm beside the chain.
- Tighten its locking nut using the M15 wrench (G).

**1**

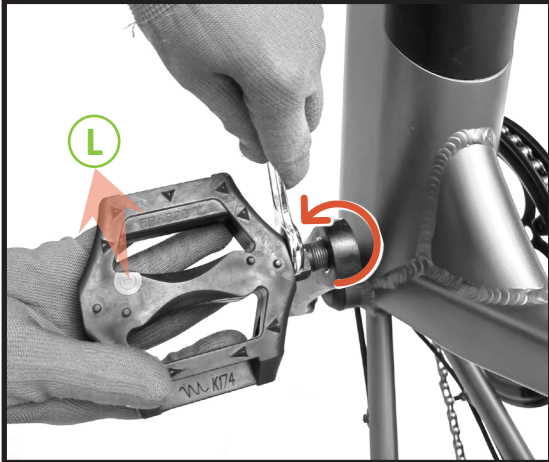

- Attach the pedal labeled **L** (6) to the remaining crank arm at the left side.
- Tighten its locking nut using the same tool.

## 4.9 Post-Assembly Actions

### **Caution**

Remember to take the following post-assembly actions to ensure optimal functionality for a safe and enjoyable riding experience.

Failure to do so may result in unpleasant riding, property damage, and personal injury.

- Thoroughly check that **ALL** components and fasteners **ARE** unbroken and securely attached.  
Pay special attention to the handlebars, pedals, fenders, saddle, and front wheel that you already installed.  
Pay **EXTRA** attention to the **chain, rear derailleur, brake calipers, rear wheels, tricycle frame connections,** and other preinstalled parts.  
See the **Extra Attention** on the right.
- Test smooth operation by rotating the wheels, steering, and pedaling.  
Make sure that **ALL** movements **ARE** fluid and free from any unusual resistance.
- Inspect the front and rear brakes by pressing their levers while pushing the tricycle forward.  
Be sure that **BOTH** brake levers can effectively engage the manual brake systems, facilitating prompt and responsive deceleration and bringing the tricycle to a smooth and controlled stop.

### **Warning**

Even when power is cut to the motor, the tricycle's inertia often demands active braking.

### Extra Attention

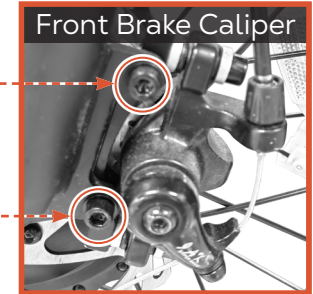
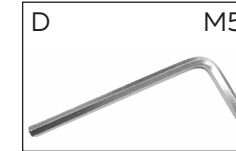
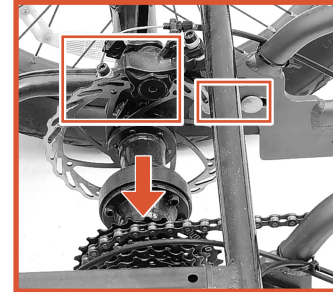

Left Side

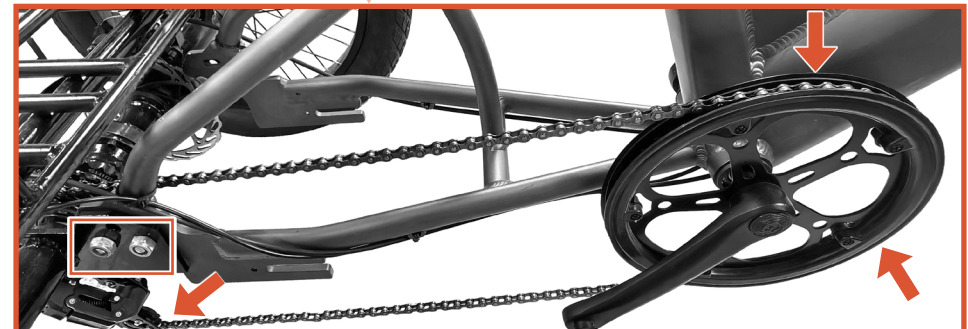
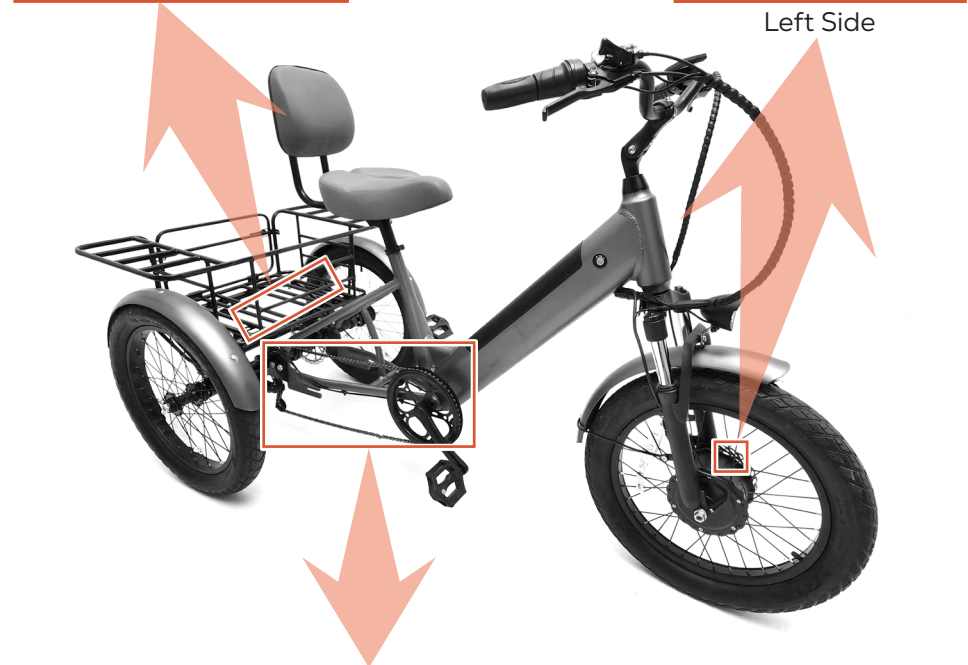

# 5. Operation

## 5.1 Charging

Pay attention to the remaining power on the display panel for each use.

When recharging is necessary, you can pull open the charging port at the battery's upper left corner and use the provided charger (A) to refill the battery.

**HOWEVER**, to prevent unauthorized start of the motor, it is recommended to remove the battery from your tricycle before charging it in a separate safe place.

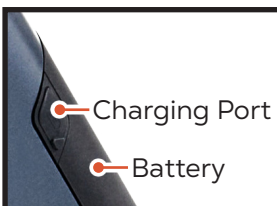

### Danger

For your safety, read the battery safety instructions in **Safety Information** on **Page 3** prior to operation.

### Caution

- **DO NOT** allow the battery to ever drain completely, which may reduce its lifespan and even make it hard to reactivate.
- **DO NOT** leave the battery connected to power once it is already fully charged, as overcharging can cause the battery to overheat, which may result in decreased performance.

**Note:** In the event that charging fails, refer to **Troubleshooting** on **Page 41** for the usual solutions.

1. Unfasten the keys (B) from the handlebars.
2. Insert either key into the socket at the right side of the down tube.
3. Turn the key completely clockwise to unlock the battery and then remove the key.
4. While holding the handlebars with one hand, pull the battery out of its compartment with the other hand.
5. Connect the provided charger to the battery's charging port and a stable compatible power source. Then, charging should begin.
6. Periodically check the state of the battery by holding its power display button and seeing how many of its indicator lights turn on. Either 3 or 4 lights should provide strong and responsive service.
7. After charging is complete, disconnect the charger from the battery.
8. Replace the battery onto the tricycle and press down on its head until it clicks into place.

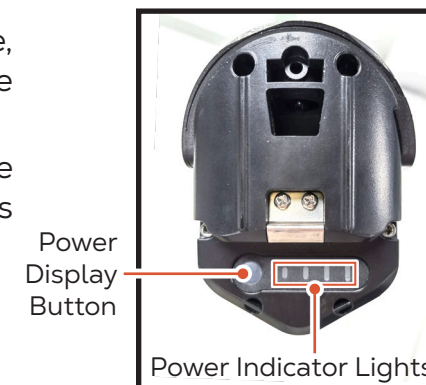
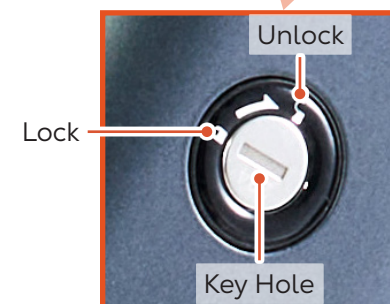

## 5.2 Turning ON/OFF the Tricycle

To turn on the tricycle:

1. Ensure that the battery remains in place in the down tube.
2. Locate the display panel on the left handlebar.
3. Hold the  button until the panel activates.

To turn off the tricycle, hold  until the panel shuts down.



### Warning

**ALWAYS** turn off the tricycle between uses or before riding with manual control

### Caution

Simply removing the battery can also turn off the tricycle without deactivating the display panel in advance.

**HOWEVER**, such abrupt cut of power is **NOT** recommended and risks damaging the tricycle's circuits and controller.

## 5.3 Throttle Control

Throttle control is available when the display panel is on, enabling your tricycle to run at the 20 mph (32 km/h) top speed using the throttle on the right handlebar.

Turn the throttle handle and stop pedaling the tricycle. Your tricycle will continue along at the top speed.

**Note:** The tricycle will not exceed its top speed on flat pavement but may do so on slopes.

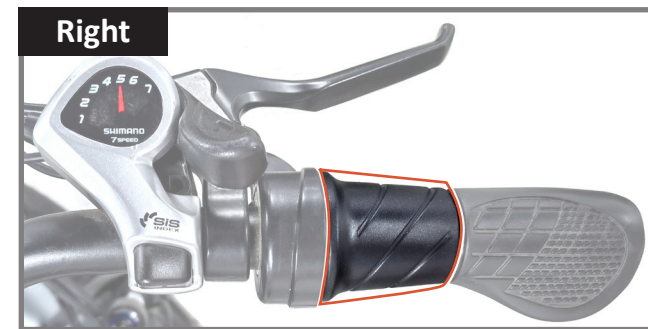

Throttle control automatically pauses and the motor temporarily shifts to neutral in the following cases:

- You release the throttle handle completely.
- You press either brake lever.
- You accelerate beyond the 20 mph (32 km/h) top speed.

The motor will resume working in the following conditions:

- You turn the throttle handle again.
- You release both brake levers.
- Your speed returns to the top speed or below.

If you begin pedaling while throttle control is active, the tricycle will activate pedal assist control.

If you turn off the display panel while throttle control is active, the motor will stop and the tricycle will only operate manually.

## 5.4 Pedal Assist Control

The pedal assist system (PAS) is available when the display panel is on, requiring you to continue using the pedals to keep the motor active but providing additional speed and strength as you ride.

The PAS has 5 levels. The tricycle will accelerate to the speed of current level as soon as the pedals fully turn two times.

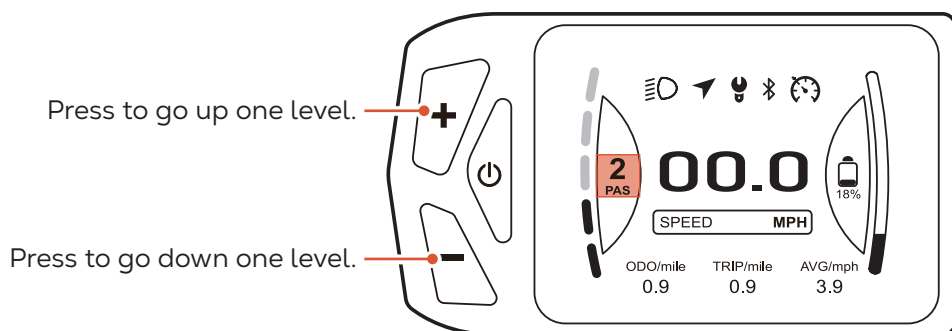

Level	0	1	2	3	4	5
Speed	–	5 mph	8.5 mph	12.5 mph	16 mph	20 mph
	–	8 km/h	14 km/h	20 km/h	26 km/h	32 km/h

**Note:** True speed will vary according to variables.

The PAS automatically pauses and the motor temporarily shifts to neutral in the following cases:

- You stop pedaling.
- You press either brake lever.
- You accelerate beyond the 20 mph (32 km/h) top speed.

The PAS reactivates in the following conditions:

- You resume pedaling.
- You release both brake levers.
- Your speed returns to the top speed or below.

If you turn the throttle while the PAS is active, the tricycle will activate throttle control and accelerate to its top speed.

If you turn off the display panel while the PAS is active, the motor will stop and the tricycle will only operate manually.

Downshifting the PAS level to **0** disables the PAS and puts the motor in neutral until the + button is pressed, restarting PAS at Level 1.

## 5.5 Cruise Control

Cruise control is available when the display panel is on, allowing you to ride the tricycle at a constant speed without turning the throttle or pedals.

1. Use the throttle or pedal assist control to reach your ideal speed ( $\geq 5$  mph or 8 km/h).
2. Hold the – button until  is displayed.
3. Release the throttle or stop pedaling.

Your tricycle should maintain its current speed without further adjustment.

4. To deactivate cruise control, press either brake lever, shifting the tricycle to neutral.

Alternatively, turn the throttle or pedals to instantly resume throttle or PAS control.

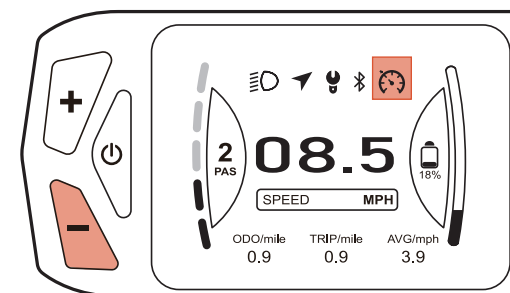

## 5.6 Push Assist Control

The push assist system is available when the display panel is on, providing additional strength as you push the tricycle for a walk or climb.

1. Stand beside the tricycle.
2. Hold the - button while pushing your tricycle forward, which will cause the motor to run at a very low speed around 2.5 mph (4 km/h).

During the process,  should be present in the PAS level display area.

3. To stop push assist control, release - or press either brake lever.

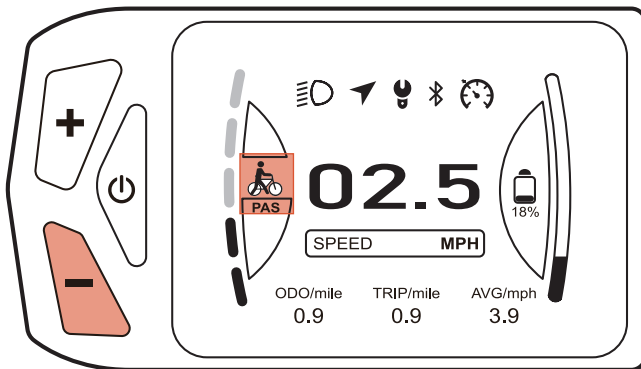

### Caution

Push assist control is **NOT** recommended in the following conditions:

- You are going down steep inclines.
- You are walking over rough terrains or obstacles.
- You are navigating through confined or crowded areas.
- You need to push the tricycle for an extended period of time.

## 5.7 Manual Control

To ride your tricycle normally, you can select any of the following methods:

- Downshift the PAS level to 0.
- Turn off the display panel.

### Caution

Simply removing the battery also allows for manual control **BUT** exposes the terminal connectors and other components inside its compartment, posing a risk of equipment damage.

## Adjusting the Speed Gearing

The gear shifter on the right handlebar uses a button and a lever to control the 7 rear cogs, providing 7-speed gearing for manual riding.

The larger the number, the smaller the cog and the faster the tricycle will turn the wheels with the same effort.

**Note:** Be sure that your tricycle's crank is turning while using the shifter to adjust the chain on the cogs.

Pull away to downshift one gear per click.





## 5.8 Navigation

Navigation is available when the display panel is connected to the mobile app **BIKEGO** via Bluetooth, offering precise turn-by-turn directions, real-time updates, and route optimization through GPS.

To set up the Bluetooth connection, refer to **6.20** on **Page 37**.

To turn on navigation, follow your app service provider's instructions.

When navigation is operating, both the  and  icons should light up on the digital display.

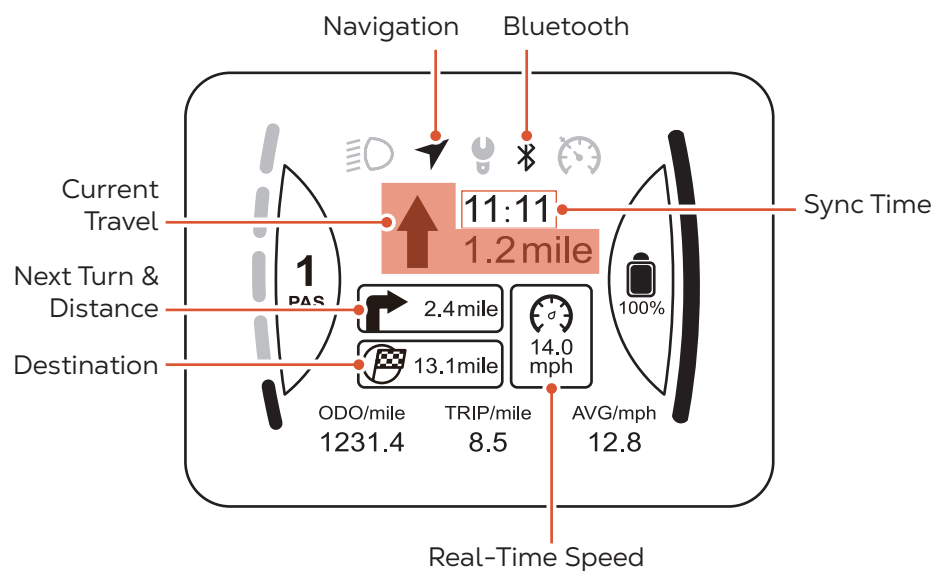



# 6. User-Defined Parameter Menus

## 6.1 General Guide

1. When the display panel is on, hold the + and - buttons simultaneously to enter the user-defined parameter menu directory (SETTING).



2. Use + or - to select a menu.



3. Press the ⏻ button to open the menu.

- In an adjustment menu, use + or - to select a desired setting.

To save your change, press ⏻ again and the directory should resume.

To cancel, wait without operation until the digital display resets by itself.



- In a display or single-selection menu, pressing ⏻ again directly resumes the directory.





4. When finished, leave the menus.

- In the directory, use + or - to select **EXIT** and then press .



- In a menu, wait without operation until the digital display automatically resets.

**Note:** Such automatic reset does not retain any changes to the settings.



 **Caution**

- NEVER** adjust the default settings in the following parameter menus randomly without professional guidance.
- These menus can be used to modify the display panel to work with other motorized wheels.
- HOWEVER**, changing any of these settings during use with this tricycle **WILL** cause it to perform abnormally, malfunction, and/or break.
- If such adjustment happens accidentally, stop the tricycle and correct the settings **IMMEDIATELY**.

Menus	Default Settings
Wheel Size	20.0
Steel Num	6
Boost Magnetic Type	12
Voltage Level	48V



## 6.2 Display Brightness

Open the **LCD Backlight** menu.

For best results, use the minimum setting that is clearly visible.

This prolongs your battery life a very little bit but more importantly allows your eyes to go between the road and the display with less readjustment in low light conditions.

- Setting **10%** is the dimmest.
- Setting **100%** is the brightest.

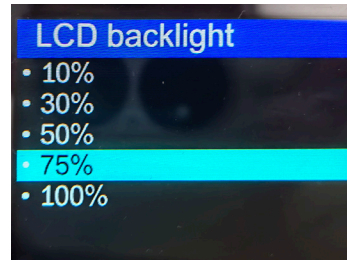

## 6.3 Measurement Units

Open the **Unit** menu.

By default, speeds and distances are displayed in imperial customary units (mph and miles).

You can toggle between this and metric units (km/h and km).

- Setting **KM** is metric.
- Setting **MILE** is imperial.

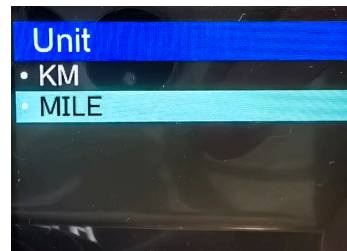

## 6.4 Timed Shutoff

Open the **Auto Off** menu.

By default, the display panel and motor will automatically shut off once your tricycle has stopped moving for 10 minutes (Setting **10**).

You can adjust the number of minutes before the display shuts down between **1** and **60**.

Decreasing this setting to **0** disables the timed shutoff, putting the panel and motor in standby mode indefinitely when you park your tricycle.

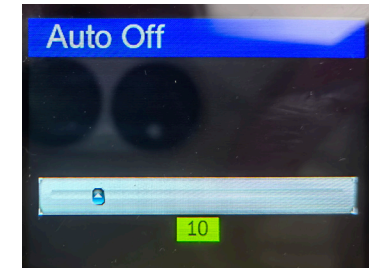

## 6.5 Wheel Diameter

Open the **Wheel Size** menu.

This modifies the system to accommodate motorized wheels with various diameters.

 **Caution**

***NEVER** adjust the default setting at random. If it is ever changed by accident, stop the tricycle and reset it to **20.0** before continuing on your way.*

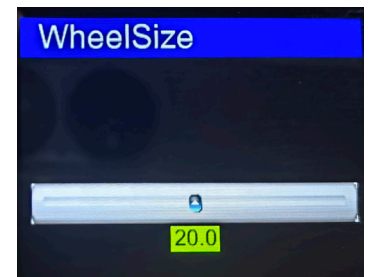

## 6.6 Speed Sensor

Open the **Steel Num** menu.

This concerns the magnet arrangement within the speed sensor.

### Caution

*NEVER adjust the default setting at random.*

*If it is ever changed by accident, stop the tricycle and reset it to **6** before continuing on your way.*

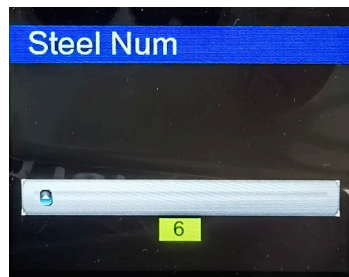

## 6.7 Top Speed

Open the **Speed Limit** menu.

By default, your motor has an overall top speed of 20 mph or 32 km/h (Setting **100**).

This controls the throttle speed and the true top speed of each PAS level in percentage (%).

### Warning

*NEVER ALWAYS observe the local and national laws and regulations on speed limit for electric bicycles and tricycles.*

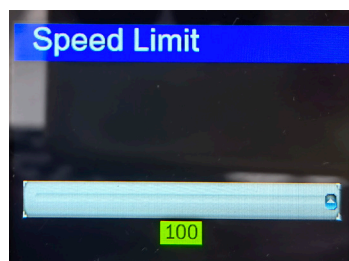

## 6.8 Throttle Start

Open the **Zero Start** menu.

By default, the throttle instantly activates the tricycle's single-speed run.

You can toggle between this and requiring two full rotations of the pedals before throttle control activates.

- Setting **On** enables instant throttle response.
- Setting **Off** enables a two-rotation start.



## 6.9 Disabling PAS or Throttle Control

Open the **Boost Drive** menu.

By default, your tricycle offers both PAS and throttle control.

You can toggle among this, enabling PAS only, and enabling throttle control only.

- Setting **Assistance** disables throttle control.
- Setting **Shifter** disables PAS control.
- Setting **S&A** re-enables both.

To disable both PAS and throttle control, simply turn off the display panel.

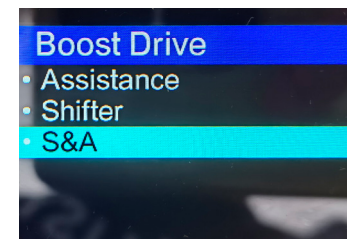

## 6.10 PAS Sensitivity

Open the **E-ABS Strength** menu.

This adjusts how quickly you need to turn the pedals to activate PAS control.

By default, the PAS activates when you turn the pedals two full rotations (**OFF**) while the display panel is on.

- Setting **Weak** requires more pedaling.
- Setting **Strong** requires less.

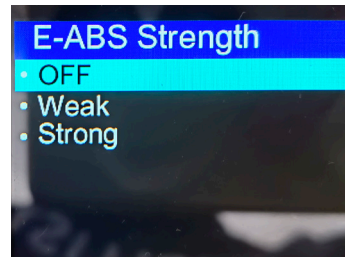

## 6.11 PAS Acceleration

Open the **Start Strength** menu.

This adjusts how quickly your tricycle ramps up the PAS speed for its current level.

Fine-tune this acceleration to suit your riding style.

Lower values accelerate more gradually and higher values more quickly.

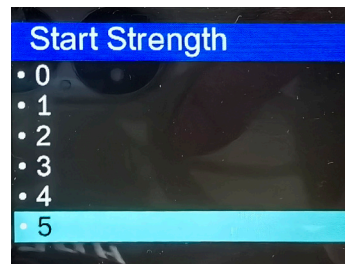

## 6.12 PAS Sensor

Open the **Boost Magnetic Type** menu.

This concerns the magnet arrangement within the PAS sensor.

### Caution

***NEVER** adjust the default setting at random.*

*If it is ever changed by accident, stop the tricycle and reset it to **12** before continuing on your way.*

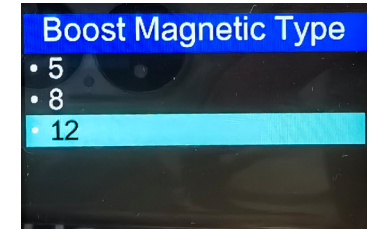

## 6.13 Resetting the Trip Odometer

Open the **Trip Reset** menu.

The total distance traveled (**ODO**) cannot be cleared.

The current trip distance (**TRIP**) and average speed (**AVG**) can be returned to **0.0**.

Hold **+** until the digital display resets, clearing the trip odometer.

Pressing exits the menu and resumes the directory.

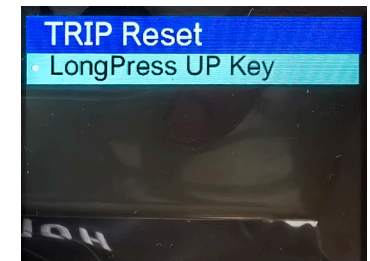

## 6.14 Fault History

Open the **Error Code** menu.

All faults that have occurred will be displayed in the form of error codes.

For details, refer to **Troubleshooting** on **Page 41**.

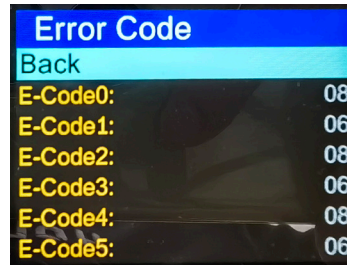

## 6.15 Bluetooth RSSI Level

Open the **BT RSSI Level** menu.

This adjusts the Bluetooth RSSI (received signal strength indicator), concerning the signal strength of the Bluetooth connection between the tricycle and a mobile device, such as a smartphone operating a bike control app.

Setting **1** requires the closest positioning of your mobile device.

Setting **5** allows for the most remote distance.

Nonetheless, any of these settings will enable the Bluetooth connection as long as your mobile device is carried with you during a ride.



## 6.16 Battery Voltage

Open the **Voltage Level** menu.

This modifies the system to accommodate batteries with various output voltages.

### **Caution**

***NEVER** adjust the default setting at random.*

*If it is ever changed by accident, stop the tricycle and reset it to **48V** before continuing on your way.*

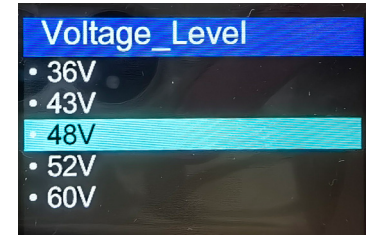

## 6.17 Disabling Cruise Control

Open the **Cruise** menu.

By default, your tricycle offers cruise control.

- To disable this, select **Off**.
- To re-enable this, select **On**.

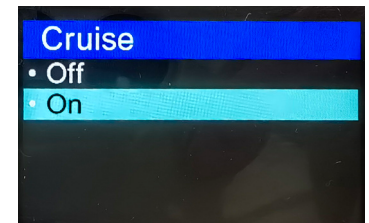

## 6.18 Menu Languages

Open the **Language** menu.

By default, **English** is the menu language.

- For Español, select **Spanish**.
- For Simplified Chinese, select **简体中文**.

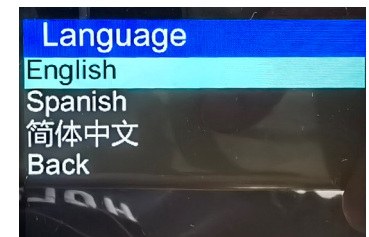

Selecting **Back** retains the current language and returns to the directory.



### 6.19 Password Protection

Open the **Password** menu.

By default, password protection is deactivated (**Off**).

Pressing **Back** exits the menu and returns to the directory.

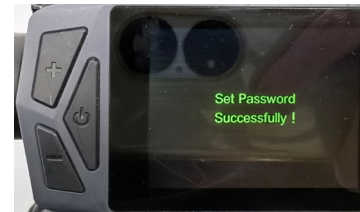
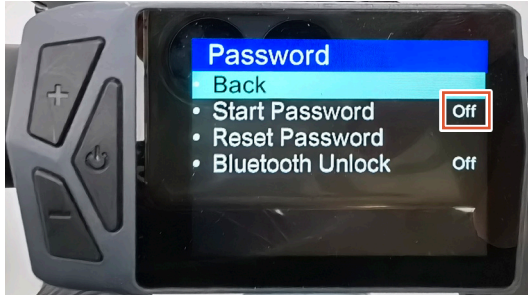

#### 6.19.1 Activating Password Protection

1. Use + or - to select **Start Password**.
2. Press to access the **Password Set** interface.
3. Use + or - to enter a number for the first digit.
4. Press to confirm the first digit and move on to the next one.
5. Repeat **steps 3-4** for the remaining digits.

Once the last digit is confirmed, password protection should activate (**On**).

**Note:** The system applies **0000** as the default password.

Next time you hold to turn on the display panel, simply enter the password and then the display should activate.

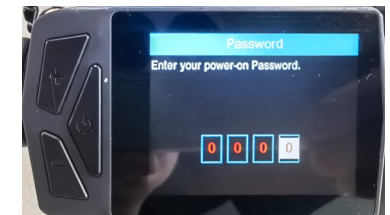

### 6.19.2 Resetting the Password

1. Use + or – to select **Reset Password**.
2. Press **⏻** to access **Password Set**.
3. Follow **steps 3–5** in **16.19.1** on **Page 35** to enter your old password and move on to the new password setting interface.
4. Enter and confirm your new password in the same fashion.

When finished, the new password is available and the **Password** menu display resumes.

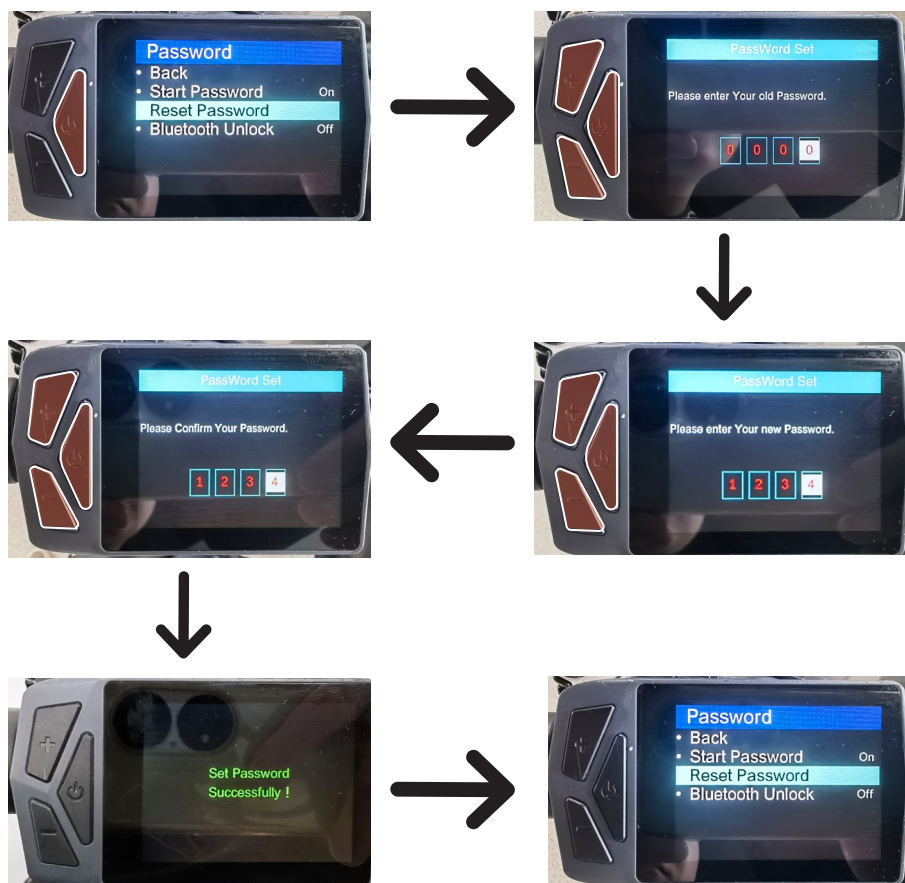

### 6.19.3 Deactivating Password Protection

1. Use + or – to select **Start Password**.
2. Press **⏻** to access the **Password Set** interface.
3. Enter and confirm your password as described on **Page 35**.  
When finished, password protection should deactivate (**Off**).

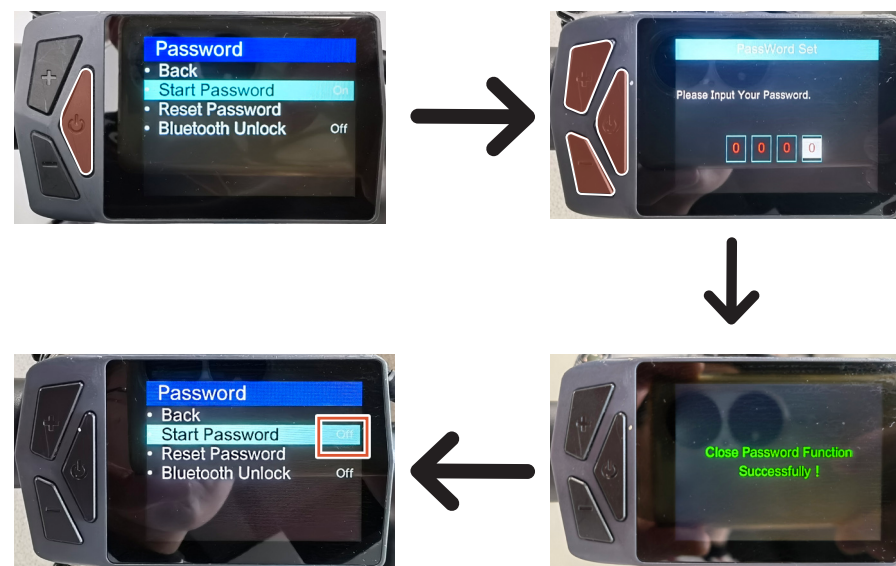



## 6.20 Bluetooth Connection

### 6.20.1 Unlocking Bluetooth

1. Open the **Password** menu.
2. Select **Bluetooth Unlock**.

By default, Bluetooth is locked (**Off**).

3. Select **On** to unlock Bluetooth.

The digital display will jump to the **Bluetooth** menu.

4. If you have ever connected your mobile device to the tricycle via Bluetooth, press  to return to the directory or wait without operation until the digital display resets.

Otherwise, follow **6.20.2** to establish the connection to your mobile device.

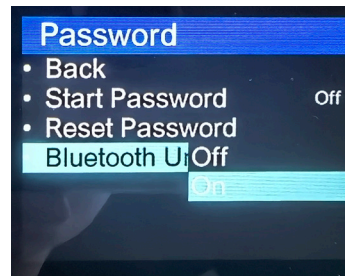
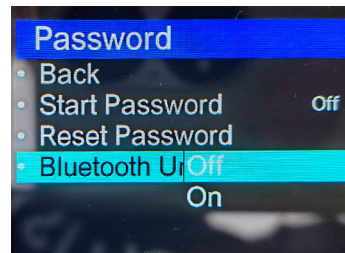
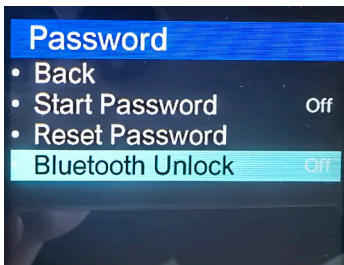

### 6.20.2 Establishing the Connection

**Note:** Ensure that Bluetooth is already activated on your mobile device.

1. Open the **Bluetooth** menu in the directory or following **6.20.1**.
2. Scan the displayed QR code using the **BIKEGO** app on your mobile device.
3. Establish the Bluetooth connection using your app.

Follow the app service provider's instructions.

You may be required to log into a valid account before operating anything.

4. When finished, wait until the digital display automatically resets.

The  icon should light up.

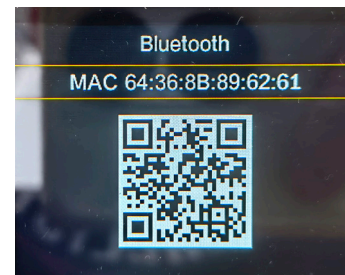



## 6.21 System Version

Open the **Display Info** menu.

**SW** refers to the software version number.

**HW** refers to the hardware version number.

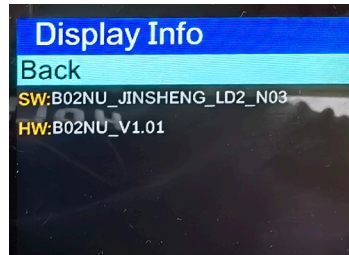

## 6.22 Restoring the Factory Settings

**Note:** This applies to the display brightness, Bluetooth RSSI level, menu languages, and password protection **ONLY**.

1. Open the **Reset** menu.
2. Select **Confirm** to begin resetting the system.
3. When restoration is complete, enter the default password (**0000**) following 6.19.1 on Page 35 to activate the display panel.



# 7. Technician-Defined Issues

## 7.1 Parameter Menus

1. In the **SETTING** directory, hold the - button to enter the **Factory Mode** directory.

Here come the **Version, Keypad, Backlight, LCD TEST, Bluetooth, USB Charger, USB LOG, and Demo Show** menus.

2. Use the + or - button to select a menu.

3. Press the button to open the menu.

4. To exit, hold + until the digital display resets.

### Caution

- These menus were designed **ONLY** for professional servicing by trained technicians.
- **NEVER** attempt to operate these menus **WITHOUT** prior training or professional guidance.



## 7.2 Quick Test

In the **SETTING** directory, hold + to activate **Quick Test**, performing a quick diagnostic test of the tricycle's electronic components and sensors before troubleshooting any potential issues.

- To start a test, press +.
- To retest, press .
- To view the historical reports, press -.
- To exit, hold - until the digital display resets.

### Caution

*If errors are reported during a quick test conducted by yourself, ask trained technicians to perform a retest and resolve the problems before further use.*



## 8. Maintenance

### Warning

*DO NOT* leave the display panel on during cleaning, maintenance, or repair. Failure to follow this may result in accidental activation of the motor, posing a series of safety hazards.

- For the longest possible service life, disconnect the battery from the tricycle between uses.
- Check the parts of the tricycle for any looseness, stiffness, wear, or damage after each use. Tighten, lubricate, repair, or replace any problematic parts before further use.

### Warning

*ONLY* use identical replacements.

- Clean the exterior of the tricycle with a soft dry or damp cloth.

### Caution

- *DO NOT* use harsh abrasives or caustic chemicals.
- All electronic components have waterproofing adequate for rain.

*HOWEVER*, avoid direct pressurized spray that might allow the interior of electronic components to become wet, *NEVER* charge the battery while it or your hands are wet, and *IMMEDIATELY* replace the battery if it ever begins to swell or leak fluid.

- If the tricycle is not to be used for an extended period, remove the battery and store everything in a cool dry place inaccessible to children and away from direct sunlight and rain.

Avoid storing electronics in plastic bags, which might allow humidity to build up over time.

For best results, check the battery every three months. If its power sinks below  $\frac{3}{4}$  (3 of the 4 indicator lights), recharge it to at least that full before returning it to storage.



# 9. Troubleshooting

## 9.1 Error Codes

Codes	Implications	Solutions
04	Throttle Mispositioned	Push the throttle forward into place.
05	Throttle Fault	Seek professional assistance from trained technicians.
06	Undervoltage Lockout	
07	Overvoltage Lockout	
08	Hall Effect Sensor Fault	
09	Motor Phase Fault	
11	Temperature Sensor Fault	
12	Current Sensor Fault	
13	Battery Overheated	
14	Motor Overheated	
21	Speed Sensor Fault	
22	BMS Fault	Ask your local dealer or contractor for a new identical battery.
30	Communication Fault	Seek professional assistance from trained technicians.

## 9.2 Other Issues

Problems	Solutions
Charging fails.	Ensure the charger is firmly connected to the battery's charging port and a working power source.
	Revive the battery in an over-low-power state. <ol style="list-style-type: none"> <li>1. Reinstall the battery onto your tricycle.</li> <li>2. Raise the motorized front wheel.</li> <li>3. Run the motor using the throttle for a while.</li> <li>4. Stop the motor, disconnect the battery, and restart charging.</li> </ol>
The throttle, PAS, push assist, or cruise control does not work.	Replace the charger or battery with a new identical one.
	Ensure the battery is seated in place.
	Ensure the display panel is already on.
The password is forgotten.	Ensure such control is not disabled.
	If no new password is already set, simply enter the default <b>0000</b> .
Bluetooth connection or navigation fails.	Contact customer service or your local dealer or contractor for professional assistance.
	Ensure Bluetooth is unlocked on the display panel and active on your mobile device.
	Make sure the app you are using is <b>BIKEGO</b> .
	Be sure to log into a valid <b>BIKEGO</b> account.
	Select higher settings in the <b>BT RSSI Level</b> menu.

Problems	Solutions	
The chain cannot be exactly positioned on the smallest cog at the highest gear (7).	Adjust the high-limit screw (H) with the Phillips screwdriver until the guide pulley and the smallest cog are lined up.	 <p>Rear Deraillieur</p>
The chain cannot be exactly positioned on the largest cog at the lowest gear (1).	Adjust the low-limit screw (L) with the Phillips screwdriver until the guide pulley and the largest cog are lined up.	

## Disposal

Electrical products should not be disposed of with household products. In the EU and UK, according to the European Directive 2012/19/EU for the disposal of electrical and electronic equipment and its implementation in national laws, used electrical products must be collected separately and disposed of at the collection points provided for this purpose. Locations in Australia, Canada, and the United States may have similar regulations. Contact your local authorities or dealer for disposal and recycling advice.

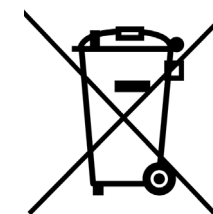

A B E - F 1 A B - A B  
A B E - F 1 A B - A L  
A B E - F 1 A B - A R  
Rev. 27 Aug. 2024